



Welcome to DAVIESS COUNTY *Indiana*

WASHINGTON

2019-2020 Chamber of Commerce member directory & community profile

Your bank. For Daviess County.



Our clients and community are at the heart of all we do. You become our first priority from the moment you walk through the door at Old National. Whether you're opening a checking account or need a loan, our local team is focused on delivering outstanding personal service. Stop by, give us a call or visit us online to learn how we can provide the best financial solutions for every aspect of your life.



OLD NATIONAL BANK[®]

Your bank. For life.[™]

Washington 311 SE 21st St 812-257-3040

**“WE’RE JUST DOWN
THE ROAD”**



877-554-BELT

www.Belttech1.com

PO Box 620 Washington, IN 47501



26



20

Contents

6

LETTER FROM THE DIRECTOR

7

LETTER FROM OUR SENATOR

8

HISTORY

10

RESIDENTS WHO CALL
DAVISS COUNTY HOME

16

CHURCHES

18

DAVISS COUNTY EQUALS
MORE BANG FOR YOUR BUCKS

20

EVENTS NOT TO MISS

22

UNIQUE EATS & TREATS

26

AGRICULTURE & INDUSTRY

28

NSWC AND WESTGATE
MAKE GOOD NEIGHBORS

30

IN THE NEIGHBORHOOD

32

DAVISS COUNTY MAP

34

LODGING

38

EDUCATION

46

THINGS TO SEE & DO

50

MEMBER DIRECTORY



28



30



16



8

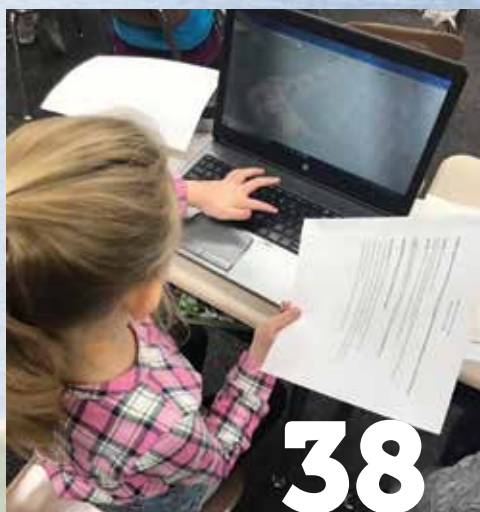

38

Contributing writers and photographers: Kerri Boyd, Melody Brunson, Mike Grant, Todd Lancaster, Greg Litherland, the late Kelly Overton, Lindsay Owens, Tori Peterson and Steve Smith

Providing Protection

is what we do best.

- Auto •Home •Life •Medicare Supplement
- Business •Crop Insurance



Best Insurance / Best Insurance Agent



Terri Kelso
OWNER
terrikelso@att.net



Washington
812-254-7770

Loogootee
812-295-5777

www.terrikelso.com

[A NOTE From the Director]



Whatever your interest, we invite you to experience this place we love and find a place to relax here.

Welcome! The Daviess County Chamber of Commerce and Visitors Bureau is proud to present the 2019-20 Profile and Membership Directory. I encourage you to use this valuable resource to learn about all the many different areas in our region that make this community a great place to locate.

Chamber members are the only businesses you will see advertised in this directory and we hope you will take the time to notice those who support our community by being a Chamber member. By patronizing our members, you are helping to keep your money local and strengthening our economic climate. Our Chamber is a strong organization of the business community that unites businesses, professional firms, corporations, non-profit organizations, and government entities.

Your Chamber does its best to be a resource to businesses and individuals as a clearinghouse for information and events. We provide business leadership opportunities, a forum for the exchange of ideas, communication of community events, and business partnering opportunities. Members know about the benefits package that comes along with being members and we are always looking for ways to grow that offering.

Please keep this directory and use it as a guide to find those businesses and organizations you need. We have included many different areas like education, health care, churches and events that take place here in our community that make us unique. We use this directory to introduce others from outside of Daviess County to our offerings and highlight key localities of pride.

If you are not a member of our organization, please call me so I can explain to you what you're missing. We are excited about the future growth of anticipated new businesses and hope you will be a part of the momentum we have as well as the commitment to building our strong community. Whatever your interest, we invite you to experience this place we love and find a place to relax here. We consider it to be one of the greatest places on earth to call home.

A stylized, cursive handwritten signature in black ink. The signature reads "Samantha Bobbitt".

Samantha Bobbitt
Executive Director, Daviess County Chamber of Commerce

A NOTE [From our Senator]



Daviess County is the perfect place to visit on a trip through Southern Indiana. From touring Amish country to our numerous fairs and festivals and a multitude of outdoor activities, Daviess County has plenty of fun for the whole family! Plan your trip and come visit us soon! We'd love to have you!

Eric Bassler
State Senator, District 39

APPAREL

T-SHIRTS • HOODIES • HEADWEAR
OUTERWEAR • TUBIES • MORE

STICKERS

LOGOS • PRODUCT LABELS • BRANDING
CUSTOM SHAPE • WEATHERPROOF • MORE

BANNERS

VINYL BANNERS • WALL ART • X-FRAME
ROLL UP • PILLOWCASE • MORE

PROMOS

DRINKWARE • SUNGLASSES • JOURNALS
CAN COOLIE • OVER 100,000 ITEMS

PRINT

BUSINESS CARDS • POSTCARDS
BROCHURES • RACK CARDS • MORE

DESIGN

CUSTOM DESIGNS • MOCKUPS
LOGOS • BRANDING • MORE



812-644-7745
888-644-7745

info@stickersandmore.com

stickersandmore.com
CUSTOM PRINTING & DESIGN SINCE 1995

Online
division of

Indiana
Forms & Labels

[DAVIESS COUNTY HISTORY]

The founding of nearby Vincennes in the 1730s by French Jesuits brought more settlers.

The land was claimed by Britain after the French and Indian War in 1763, and then by the newly-formed United States after the American Revolution in 1783. George Rogers Clark, whose victory over British General "Hair-Buyer" Henry Hamilton in February of 1779 secured the Northwest for the United States, reportedly camped in the northeastern part of the future Daviess County in the 1780s.

A town in this region would be called Clarksburg in his honor; the name changed to Odon later in the 19th Century.

The first permanent white settler in the Daviess County region was

William Ballow, who reached the Sugar Creek Hills in present-day Reeve Township in 1801. New settlement continued until the War of 1812 and the town of Liverpool

was founded. For three years, conflict with the British and Native Americans caused new settlements to stop, and existing settlers built a series of forts to protect them.





After the war, Liverpool was given the more patriotic name of Washington. After Indiana gained statehood, Daviess County was formed in 1817. The boundaries were altered numerous times, eventually reaching their current state in 1828.

Construction of the Wabash and Erie Canal reached Daviess County in 1847, with the towns of Maysville and Plainville becoming important canal depots. Although the canal was short-lived and a logistical and financial disaster, it affected settlement of the county through the influx of Irish laborers who stayed and as a means of transportation for the brief time it was open in the 1850s and 1860s.

It was the coming of the railroad which provided the spark to create much of modern Daviess County as we know it. In 1857, the Ohio and Mississippi Railroad between Cincinnati and St. Louis was completed. Washington grew quickly, becoming the county's first incorporated city in 1871.

The 20th Century saw the slow decay in importance of railroads (last passenger service was in 1971) and small farms nationwide with that impact reflected on the Daviess County population and economy. During World War II, the Crane NWSC naval base was opened in Martin County with considerable effect on the region. Also in the 20th Century, we saw the growth of oil

and gas well production.

The southern part of the county was impacted by the Glendale Fish and Wildlife area, which was started in the 1950s. The Old Order

It was the coming of the railroad which provided the spark to create much of modern Daviess County as we know it.

Amish, a reclusive, traditionalist religious group whose members first arrived in Daviess County in 1868, saw their economic and cultural influence rapidly increase in the latter part of the century through farming, the construction industry, tourism and a rapidly-growing population, now topping about more than 5,000 residents, not including their neighbors all around the county – a large Mennonite group as well.

During the first two decades of the 21st Century, the growth of a diverse manufacturing base and the West Gate Tech Park in the northeastern section of the county has brought jobs and growth. Interstate 69 was completed through Daviess County in late 2015, and has led to more potential growth of business and industry on Washington's east side.

HAAG

Heating & Air Conditioning, Inc.

"Whatever it takes"

Washington, IN

812-254-4561



The Legends Village
An Assisted Living Community

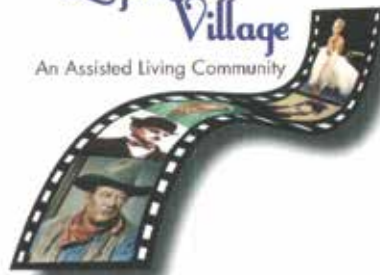

**1764 Troy Road
P.O. Box 654
Washington, Indiana 47501
812-254-9500**

*"You'll Love Living
at The Legends"*

**Locally Owned and Operated
For over 10 Years**

Enjoy resort style living at The Legends Village at our area's lowest rates for assisted living. Larger apartments — better service — lower rates --- a win win for everyone.

RESIDENTS WHO CALL DAVIESS COUNTY HOME



Yasuhiro (Yasu) Ito

Few area residents have traveled farther than Yasuhiro (Yasu) Ito to make Daviess County their home.

Yasu, 61, relocated to Daviess County in 2017 to serve as president of M & C Tech (Indiana Corporation); his relocation spanned approximately 6,300 miles, and he believes the trip was well worth it.

"People made me feel welcome," Yasu said through his interpreter, 23-year-old Mari Kubota. He added that his first few months were difficult due to communication issues, but, by way of computer-generated translation, he and

fellow residents were able to talk until his translator arrived in Washington.

His arrival was not without some trepidation as he was used to living and working in much-larger cities; he was concerned about being able to attract and retain quality and qualified employees in a community the size of Daviess County (approximate population of 33,000).

"As it turns out, Daviess County is a great place," Yasu said, adding, "everything is great and my (35) employees do a great job; we are like family here."

His company manufactures automotive extrusion products,

which can be categorized generically as parts for sunroofs.

In 2010, Yasu led a similar foreign start-up venture in China, and was the company's choice to start the production line in Daviess County. Yasu, the father of two children and grandfather of two (with another grandchild on the way), has been with the company for more than 40 years as he started with the company immediately after he earned his college degree in chemical engineering while in Japan. He never thought he would leave Japan.

"This has been a very good move," Yasu said, "even though I miss Japanese food."

Bob & Jo Arthur

Bob and Jo Arthur have made Washington their home for 43 years and never once considered leaving.

"This is home," Bob, a retired judge, commented, adding, "We never have given relocation any serious thought."

And, that is quite an accomplishment as his wife, who grew up in Sullivan County, wasn't certain Daviess County was where she wanted to settle.

"My graduate work may have brought me here, but friendship and community keep me here." — Jo Arthur

Jo was busy with her Georgia Tech University under-graduate work, which brought her to Washington in 1976. She felt welcomed when she arrived, met Bob in the process, and the two have made Washington their home ever since.

"My graduate work may have brought me here,

but friendship and community keep me here," Jo noted.

The couple is free to move since all three grown children have been out of the house, but the pair has no intentions of leaving.

"Everything we need is here," Jo said.

Bob pointed out that Daviess County is the ideal spot because it is close enough to metropolitan areas that it is an easy drive if one wants to go there.

While friends in Florida have encouraged the Arthurs to sell their Daviess County residence and move south, the Arthurs are not interested.

"It is nice to visit Florida, especially in the winter, but we're too happy in Washington to move," Jo remarked.

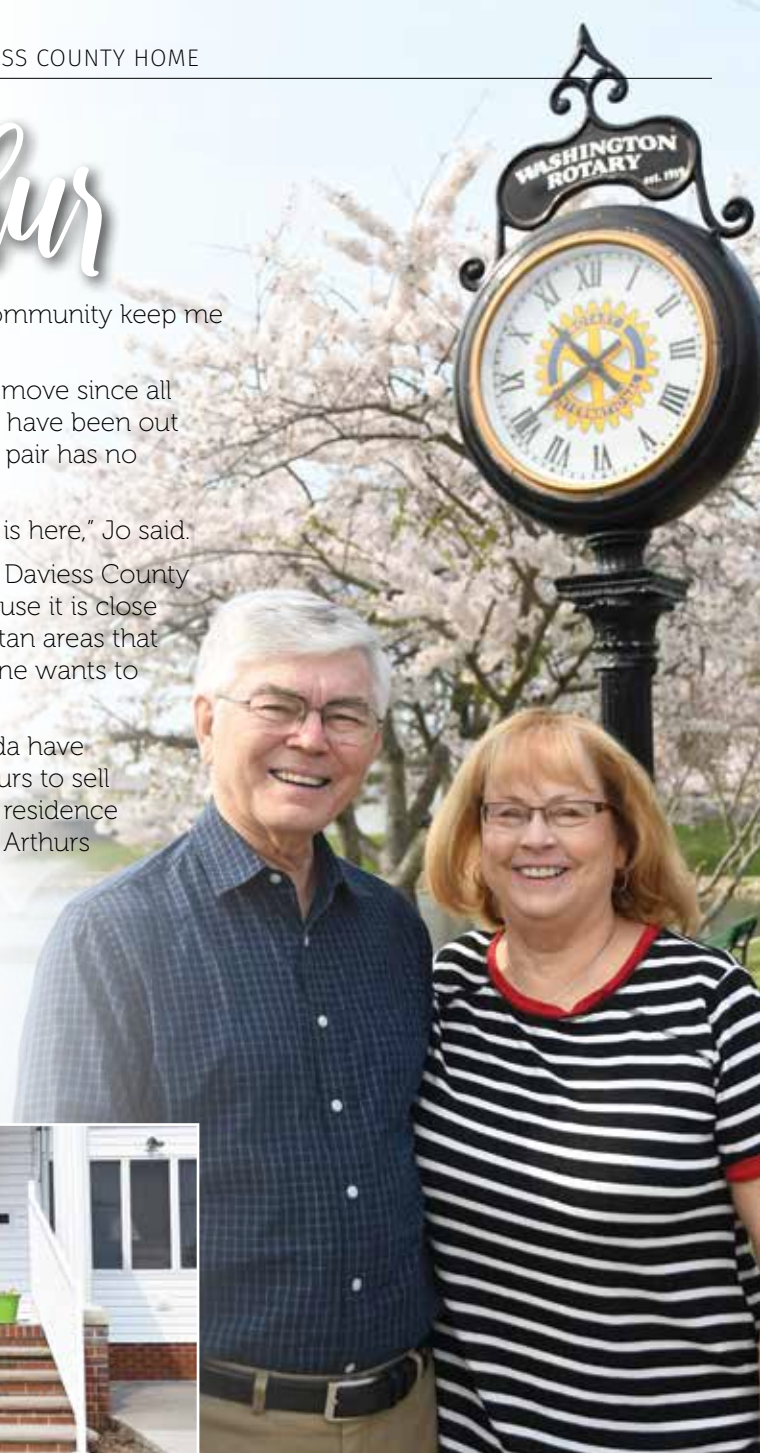

Kimberly Wagler Parsons, DDS
Excellence in Family Dentistry

2 East Walnut Street
Washington, Indiana 47501

812-254-4684

**LAKESIDE
STORAGE**

Units of All Sizes

1 Month Free, with 6 Months Paid

812-295-5018

5458 N 1200 E • Loogootee, IN



Ginger & Bryan Porter

Momma P, the Science T and Bryan P, the M.D., are two who are deeply-rooted in Daviess County.

Bryan Porter, who has a medical practice in Odon, is married to Ginger, a fifth grade science teacher at North Daviess Community Schools. The two have been married for 32 years and call Daviess County home.

The Porters grew up in the

northern part of Daviess County but moved around the country and the globe as Bryan was a doctor in the U.S. Air Force after graduation from Indiana University's School of Medicine.

"I loved all of the travel that we did while Bryan was in the service, but we knew when we started a family that Daviess County was going to be where we were going to settle," Ginger said.

They knew Daviess County was going to be there home as

Bryan wanted to give Ginger the opportunity to put to use the degree she earned.

"She worked various jobs unrelated to teaching to help me through

"We knew when we started a family that Daviess County was going to be where we were going to settle."
— Ginger Porter

medical school," Dr. Porter noted. "And I wanted to move back to Daviess County to give her the opportunity to put her degree to use."

Putting her degree to use may be an understatement as she has connected with her students not only at North Daviess, but also the students who check out videos on YouTube. Her teaching career has cemented the couple's place in the county.

As for Dr. Porter, even though he was content with the war life in the Air Force, he knew his family needed to have a stable environment. To him, the choice was simple: Daviess County.

"Once we were here, we were here for life," Dr. Porter commented.

For All Your Automotive & Towing Needs
WAGLER AUTOMOTIVE INC.



6276 East 1000 North
Odon, IN 47562



JASPER 
ENGINES & TRANSMISSIONS

Bus: 812-636-8177
 Fax: 812-636-8171
 24Hr. Tow:
 812-486-9265

We, the owners, are
"Caring for you when you need care the most."

Ed Lee Mortuary has been Locally Owned and in the Community Since 1929



Ed L. Lee
mortuary

101 North Meridian Washington
 812-254-3612
www.edleemortuary.com

Comfort. That single word sums up attorney Brandon Smith's defense for choosing Daviess County as his place to practice law and live.

"There are so many reasons to live in Daviess County," Brandon noted, "and quality of life is one key reason".

Not all of those reasons hit home until he left Daviess County.

He, as is the case with many teenagers, was looking forward to leaving Daviess County and starting a new life.

"But, the longer I was away from here, the more I realized I wanted to live in Daviess County," he said.

A 2001 Washington High School graduate, Brandon

wasn't sure initially what profession he wanted but he was certain — or at least he thought he was certain — he would not land in Daviess County. He had considered Bloomington (Monroe County) as a possibility but felt the pull of Daviess County.

It was during his time in law school at Indiana University's School of Law that he had his epiphany relative to where to practice and live.

"Daviess County is a place that is comfortable and familiar, but, more than that it is a place of community," the attorney commented.

Brandon Smith



Phil Stoll Construction
812-486-9830

NEW HOMES
METAL ROOFING

PSC

POST FRAME BUILDING
CONCRETE



Quality Craftmanship



Dependable, Honest Contractor



Professional, Customer Satisfaction



Job opportunities were plentiful after graduation from Purdue University, but both were in agreement: Daviess County is the place for them.

Blane & Hillary Lawyer

Blane and Hillary Lawyer could have chosen to live anywhere they wished as they both are working professions that have high demand, but, to the Lawyers, the decision where to live was a no-brainer: Daviess County.

For Blane, a pharmacist, and Hillary, an adult nurse practitioner, job opportunities were plentiful

after graduation from Purdue University, but both were in agreement: Daviess County is the place for them.

Both were born in Daviess County and spent most of their lives here. While both were excited to attend Purdue University, both knew — after just one semester — they would earn their degrees and return to Daviess County to work and also to start their own family.

"Washington and Daviess County have a small-town feel to them," Hillary said, adding, "but both Washington and the county are growing and it is nice to be a part of that."

Blane agrees, and notes that his time away at Purdue helped him gain an even greater appreciation for what Daviess County has to offer.

PRESCRIPTION SHOPPE

2005 State Street,
Suite B,
Washington, IN 47501

254-7666

COMPLETE PHARMACY SERVICES

Locally owned & operated - Ken Holland P.D.

Giving Never Tasted
So Delicious!

Cathy McKown
Copper Leader

812-486-7476 • cathymckown64@gmail.com
<http://tastefullysimple.com/web/cmckown>

*A home that provides award-winning care...
where each one is a loved one.*



Outpatient Therapy Available to All Ages and 7 Days a Week



Coming in 2020



**We Are Your
#1 Choice for
Rehabilitation!**



**Call 812-636-4920 or Visit www.ketchammemorial.com
601 E. Race Street - Odon, IN 47562**



Churches

Alfordsville

ASSEMBLY OF GOD

54 Hendrickson Lane

ALFORDSVILLE CHRISTIAN CHURCH

6386 S. Church St.

ALFORDSVILLE UNITED METHODIST

6600 S. Church St.

Loogootee Barr Township

ST. MARY'S BARR TOWNSHIP CHAPEL

CR 1200 E

Loogootee

Cannelburg

ALL SAINTS CATHOLIC CHURCH

1049 N 900 E

BEREA MENNONITE CHURCH

216 S. Main St.

Corning

ST. PATRICK'S CHAPEL

800 E 500 S

Elnora

ELNORA CHRISTIAN

201 S. Meridian St.

ELNORA CHURCH OF CHRIST

Highway 57 N

ELNORA UNITED METHODIST

105 E. Meridian St.

Glendale

OAK GROVE COMMUNITY CHURCH

875 E 700 S

LIVING WATERS MENNONITE

CR 600 S

WACO CHURCH OF CHRIST

1 mile east of Glendale Dam

Maysville

MAYSVILLE UNITED METHODIST CHURCH

U.S. Business 50 W

Montgomery

FIRST MENNONITE

8002 E 550 N

MONTGOMERY CHRISTIAN CHURCH

U.S. Highway 50 E

MT. OLIVE MENNONITE CHURCH

378 S 800 E

PROVIDENCE MENNONITE

4738 E. U.S. Highway 50E

ST. PETER'S CATHOLIC CHURCH

305 N. Second St.

ZION AMISH-MENNONITE

CR 900 E

Odon

BAILE CHURCH

700 E 1250 N

BETHEL MENNONITE

9335 N 900 E

CHURCH OF GOD - SHILOH

9054 CR 1000 N

MT. JOY CONSERVATIVE FELLOWSHIP

10017 CR 1080 E

ODON FIRST BAPTIST

119 E. Main St.

ODON FIRST CHRISTIAN

208 S. Spring St.

ODON NAZARENE

633 E Elnora St.

ODON UNITED METHODIST

602 E. Elnora St.

SECOND MT. OLIVE

12220 E SR 58

PLEASANT HILL COMMUNITY CHURCH

15008 900 E

UNION CHAPEL MENNONITE CHURCH

10703 E. 1400 N

Plainville

PARKVIEW CHRISTIAN

800 S. West St.

PLAINVILLE CHRISTIAN CHURCH

283 Williams St.

PLAINVILLE UNITED METHODIST CHURCH

102 Church Lane

CANNAN FELLOWSHIP

CR 550 E



Raglesville**RAGLESVILLE UNITED METHODIST**

9956 N. Cross St.

Washington**ANTIOCH CHRISTIAN CHURCH**

3007 E U.S. Highway 50 E

AIKMAN CREEK CHURCH

E 700 South

BETHANY CHRISTIAN

1139 S. SR 57

BETHEL UNITED METHODIST CHURCH-SOUTH

3709 South 50 W

BETHEL UNITED METHODIST CHURCH-NORTH

919 N SR 57

BEULAH AME

805 W. Walnut St.

BIBLE BAPTIST MISSION

1351 S. St. Rd. 57

BREAD OF LIFE - FULL GOSPEL CHURCH OF JESUS CHRIST

1315 W. McCormick Ave.

CALVARY BAPTIST CHURCH

1604 E. National Highway

CALVARY MISSIONARY CHURCH

215 W. Main St.

**CENTRAL CHRISTIAN**

10 W. Van Trees St.

CHRIST UNITED METHODIST

104 N. Meridian St.

CHURCH OF THE NAZARENE

1 E. National Highway

CHURCH ON THE WAY

700 W. VanTrees St.

DEEP WATERS

101 W. Main St.

EBENEZER GENERAL BAPTIST

400 Oak Grove Road

FAITHWAY BAPTIST CHURCH

1704 SR 57 S

FIRST BAPTIST CHURCH

100 E. Walnut St.

FIRST CHRISTIAN CHURCH

117 N.E. Third St.

FOUNTAIN OF LIFE UPC

1600 S 75 E

FREE METHODIST

1155 Troy Road

GOOD SHEPHERD LUTHERAN

1002-1/2 N.E. Sixth St.

GRACE BAPTIST CHURCH

418 Highland Ave.

HARVEST FELLOWSHIP

200 W. Main St.

KINGDOM HALL OF JEHOVAH WITNESSES

1793 S 75 E

WASHINGTON ASSEMBLY OF GOD

320 S. Meridian St.

MT. GILEAD UNITED METHODIST CHURCH

S 100 E

MT. OLIVET CUMBERLAND PRESBYTERIAN

SR 57 S

NEW HOPE CHRISTIAN CHURCH

559 E 100 S

OUR LADY OF HOPE CATHOLIC CHURCH

315 N.E. Third St.

PLEASANT HILL UNITED METHODIST CHURCH

4587 S 100 E

ST. JOHN'S EPISCOPAL

509 E. Walnut St.

SOUTHWIND WESLEYAN

1782 Troy Road

TEMPLE BAPTIST CHURCH

2893 SR 57

TRINITY GOSPEL TABERNACLE

1600 State St.

VEALE CREEK BAPTIST CHURCH

150 S 175 E

VICTORY COMMUNITY CHURCH

1419 W Walnut St.

WASHINGTON CHURCH OF CHRIST

311 Hillside Drive

WESTMINISTER PRESBYTERIAN

110 N.E. Second St.



DAVISS COUNTY EQUALS MORE **BANG** FOR YOUR **BUCK\$**

LOOKING TO RELOCATE?

Daviess County just may be the best choice you could make.

More than 32,000 people already know what an independent research group recently published: Daviess County provides quite the Bang for the Buck.

SmartAsset, a web-based financial planning site, released results of its fifth annual study relative to Indiana property taxes, and Daviess County

ranked second in the state in what SmartAsset terms Overall Value Index. Daviess County's Overall Value Index was a mere .57 behind Jay County as **Daviess County's index was 98** compared to Jay County's index of 98.57.

The index is the result of researching metrics such as: Quality of schools,

local crime rates and property taxes, in an attempt by SmartAsset to pinpoint where people and businesses realize the most value for their tax dollars. The following chart shows the rankings published by Smart Asset in February 2019.

Rank`	County	Tax Rate	School	Crimes Per 100K	INDEX
1`	Jay	0.62	9	521	98.57
2	Daviess	0.76	6	299	98
3	Tipton	0.7	8	386	97.77
4	Starke	0.74	2	122	97.06
5	Hancock	0.88	9	368	96.98
6	Lagrange	0.58	8	553	96.6
7	Tippecanoe	0.76	7	434	96.04
8	Franklin	0.63	9	622	95.89
9	Brown	0.49	9	653	98.85
10	Wells	0.53	7	704	95.77

It should be noted that "Crimes per 100,000 people" is estimated for counties that do not have 100,000 residents. Daviess County's population (at the time of the study) was 32,777. Data used to support the findings is contained in U.S. Census Bureau 2017 American Community Survey, Department of Education, Federal Bureau of Investigation, and State Police or Justice Department websites.

The study is not commissioned by any agency or municipality; rather, it is SmartAsset's attempt to identify where industry, retail and residents might consider locating.

Not included in the study is the unemployment rate, which would have improved Daviess County's position. Hoosierdata.in.gov posted 2018 non-seasonally adjusted unemployment rate, and **not only did Daviess County beat the state average, it posted the lowest unemployment rate in a four-county area.** To the right is a chart that compares counties Daviess, Knox, Martin and Pike to the state unemployment rate.

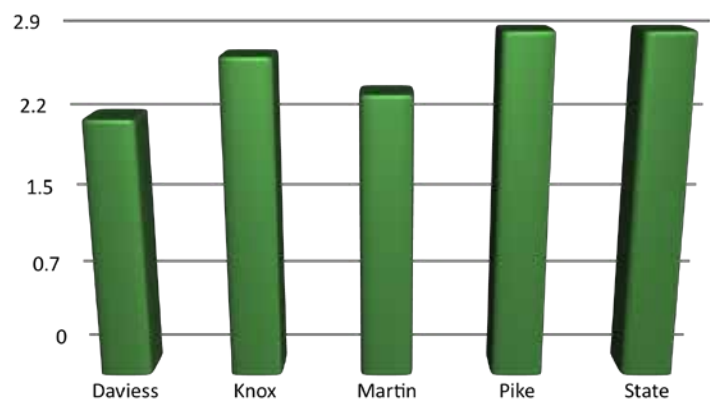

The unemployment numbers, as well as data that points to value, show Daviess County provides Bang for the Buck.



WHITE RIVER VALLEY

Antique Association

First Weekend After Labor Day

Located on Daviess County Fairgrounds - Elnora, IN

Admission \$5 - Age 12 and under Free

Free Parking - wrvaa.org



Spring & Fall Events

Free Admission



Fall 2019:

Home Spun Holiday Market

2nd Saturday in November

Spring 2020:

Swap Meet & Barn Market

1st Saturday in April

Fall 2020:

Home Spun Holiday Craft Market

2nd Saturday in November



EVENTS

NOT TO MISS

JANUARY

NEW YEAR'S HORSE & TACK AUCTION

January 1
Dinky's Auction Center,
Cannelburg
812-486-2880 ▼



MARCH ▲

SOUTHERN INDIANA SPRING DRAFT HORSE, CARRIAGE AND MACHINE AUCTION

First Wednesday through Friday in March
Dinky's Auction Center,
Cannelburg
812-486-2880

APRIL

WHITE RIVER VALLEY ANTIQUE ASSOCIATION SWAP MEET

First Saturday in April
South of DC Fairgrounds (WRVAA Grounds), Elnora
Contact Ben Chestnut
812-636-4209.

MAY

MEMORIAL WEEKEND CELEBRATION, WEST BOGGS PARK

Honor those who have lost their lives serving our country with a Memorial Ceremony and an evening with candlelight vigil around the park at 8:30 p.m.
Call (812) 295-3421.

SPECIAL HORSE AND TACK AUCTION

On Memorial Day, 3 p.m.
Dinky's Auction Center,
Cannelburg
812-486-2880

JUNE

WASHINGTON CATHOLIC SUMMER SOCIAL

First Sunday in June
Elementary & High School
Washington grounds
812-254-2781



CELEBRATE WASHINGTON

Third Saturday in June
Heartbeat of Washington event on Main Street
Call 812-254-5262.

DAVIESS COUNTY FAIR

Fourth week of June
Daviess County fairgrounds, Elnora
Contact Elizabeth Anderson (812) 486-8071. ▼



COMING HOME TO OUR IRISH ROOTS

Summer Picnic – Building on Our Irish Roots
Last Sunday in June
11a.m. – 5 p.m.
Corning Irish Heritage Center,
4962 S 800 E, Montgomery
Contact/More Information:
www.corningheritagecenter.com, Vince Sellers @ 617-2688
or email: vincent.sellers@yahoo.com for tickets.

JULY

WASHINGTON'S FOURTH OF JULY FESTIVAL

At Washington Eastside Park.
Contact Kip Kelly at 812-254-6010.

DAVIESS COUNTY 4-H FAIR

Starts 2nd Wednesday in July
Washington Eastside Park
Call (812) 254-8668.

AUGUST

ODON OLD SETTLER FESTIVAL

First week of August, Thursday through Saturday
Odon City Park
Call 812-636-8218.

AMISH QUILT AUCTION

Saturday of Labor Day Weekend
Simon J. Graber Community Building, Cannelburg
Call 812-296-1775.

SEPTEMBER

WHITE RIVER VALLEY ANTIQUE SHOW

Always Thursday-Sunday after Labor Day
Daviess County Fairgrounds, Elnora

DAVIESS COUNTY TURKEY TROT FESTIVAL

Always Thursday-Sunday after Labor Day
Ruritan Park Montgomery
Call 812-254-0938.



ANNUAL CHANDELIER BARN MARKET

First weekend in September
- Wilson Family Farms - 5060 E 350 N, Montgomery
\$5 admission.
Call 812-486-7745 or 812-486-7792

20TH CENTURY CHEVY CAR FESTIVAL

Third weekend in September
Eastside Park, Washington
Call 812-617-5580.

WINE AND BREW FEST

Last Saturday in September
2 p.m. to 10 p.m.
Main Street and Second sts., Washington
Call 812-254-5262.

NOVEMBER

NORTH DAVIESS COMMUNITY CRAFT SHOW

Second Saturday in November
North Daviess High School, Elnora
Call 812-687-7686 or 812-259-2011.

SPECIAL HORSE AND TACK AUCTION

Thanksgiving Day, 3 p.m.
Dinky's Auction Center, Cannelburg
812-486-2880



DECEMBER

WASHINGTON CHRISTMAS PARADE

6 p.m. Contact Mayor's Office at (812) 254-5575.

UNIQUE *Eats & Treats*

Are you dressed up in your date-night outfit or going casual in the jeans and sneakers looking for good eats? Or just looking to buy a new dress or sneakers, or need a quick gift idea for a special occasion? **Daviess County has you covered.**

AMERICAN FAMILY TABLE DINING

Known for its huge portions and quality comfort food, American Family Table Dining, 908 W. National Hwy., Washington, serves more breakfast than most can eat. There is an ever-changing menu of specials. Most can barely get through their stack of pancakes or breakfast skillet.

ACES

Upscale fare in a friendly, casual atmosphere, Aces, 908 Bedford Road, Washington, is the 19th hole at Washington Country Club. It features a full-service bar, an extensive beer and wine list, a unique bourbon street menu and tasty salad bar. Open for lunch and dinner, local and regional acts perform almost every Saturday night on stage.

BAKERY HOUSE

Known for its delicious pastries and home-cooked plate lunches, The Bakery House, 406 S.W.

Second St., Washington, is home of the now-famous "cronuts," and maple-bacon long johns. Specialty cakes and desserts can be made-to-order, as well as candies and jellies.

GASTHOF AMISH VILLAGE

A traditional Amish buffet in the restaurant, which can host special events and do catering, is located in the heart of Amish country north of



#1 **NOBODY IN THE WORLD SELLS MORE REAL ESTATE THAN RE/MAX**



Each Office is Independently Owned and Operated



RE/MAX
Real Estate Merchandisers
812.254.1973 510 South St.
remax-realestatemerchandisers-in.com

WB Williams Bros.
HEALTH CARE PHARMACY
Focused on your health since 1899.



- RX Delivery
- WB Med Packs
- Auto Refill
- Text Alerts and Mobile App
- Kids Vitamin Program

812-254-2497



GET A FREE QUOTE



SAFE HOME SOLUTIONS
for Aging in Place

Modify your home ROOM X ROOM

10 Williams Bros. Drive, Washington, IN
www.williamsbrosparmacy.com

DILLON AMISH TOURS
"The Original Authentic Tour"
TOUR GROUPS OF 15 OR MORE
VISIT AMISH HOME & QUILT, CRAFT & FURNITURE SHOPS
AMISH BAKED GOODS AND CANDY & FAMILY STYLE AMISH MEAL

Don't forget the
**DAVISS
COUNTY
AMISH
QUILT
AUCTION**
SATURDAY BEFORE
LABOR DAY



Mark Dillon
MONTGOMERY, IN
JOANNA 812-486-2930
MARK 812-296-1775
812-644-7111

Montgomery. An 82-room hotel in the village, 6747 E Gasthof Village Road, offers a swimming pool and glimpse of down-home country living. The village complex is home to several shops and a seasonal flea market on Wednesdays and Saturdays from May to October.

Little Houston's is on the move throughout Washington. Watch for the smokin' grill and stop by.

SCOOPS

Homemade ice cream and ice cream novelties, there is both indoor and patio seating at Scoops, 420 SR 57S, Washington.

Now with expanded parking or a convenient drive-thru, one can experience ice cream, hard or soft-serve, with ever-changing flavors. Open seasonally.

STOLL'S LAKEVIEW RESTAURANT

Excellent fried chicken on the traditional Amish buffet at Stoll's Lakeview Restaurant, 155519 U.S. 231, Loogootee, with an impressive view of West Boggs Lake. Stoll's has a full salad bar and homemade desserts. An in-store gift shop offers baked goods, jellies and décor.

EASTSIDE FLOWERS & GIFTS & COUNTRY GARDENS

Floral arrangements for gifts and décor, as well as live plants and special orders are available from Eastside Flowers, 107 E. Main St., and the new Country Gardens, 2107 State St. New owner/operator Charlie Heller at Country Garden can also help you with landscaping and perennials.



CHERRY GHOST COFFEE HOUSE

The coolest place in town, the Cherry Ghost Coffee House at 424 E. Main St., Washington, carries organic Brown County coffee and espresso, specialty drinks, organic scones and muffins, organic wraps, bagels, and more! With free Wi-Fi for your surfing pleasure, there is also live music every Wednesday and Friday night at 7!

LEMON TREE DÉCOR

Top-of-line gifts and décor from kitchen items and jewelry to baby items and boutique-style clothing, Lemon Tree Home Décor, 220 E. Main St., in the heart of Downtown Washington, is great for last-minute gifts. Free wrapping available.

LITTLE HOUSTON'S BBQ

A mobile food cart, for catering or pickup, Little Houston's BBQ is a family recipe specializing in ribs and smoked chicken salad.





▲ YOLONDA'S BISTRO

Named for its founder Yolonda Bostic, Yolonda's Bistro, 422 E. Main St., Washington, has brought together the best dishes "From LA to L.A." She has selected some of the finest cuisine from California to Louisiana. Whether it's a lobster risotto, a succulent lamb chop, a set of crispy chicken wings or smoked salmon, her cooking is sure to please. Offering Saturday and Sunday brunch options, she also has wine and beer available in a cozy setting. There's a private upstairs room or outside patio seating for your pleasure or to rent by the hour.

AMISH KOUNTRY KORNER & DUTCH PANTRY

Specialty meats and cheeses made to order are the main stay of both Amish Kountry Korner, 3516 E. National Hwy., Washington, and Dutch Pantry, 13014 N. 1100E, Odon. Both offer sandwiches made to order, homemade pies, cookies and other desserts, as well as bulk foods, and unique Amish gifts and décor. Amish Kountry Korner has a new salad bar open for lunch.

ODON LOCKER

Well respected not only in Daviess County, but all over Southwest Indiana, the Odon Locker's marinated turkey strips are staple at backyard barbeques and picnics. If one hopes to make a BBQ just a little more special, then their turkey strips, teriyaki pork chops or fresh-cut T-bones are the key. The Odon Locker, 606 W. Elnora St., also makes its own jerky, along with being a full service butcher shop, with smoked and

deli meats cut to order. Many local residents have their own meat custom butchered and packed by the Swartzentruber family. Conveniently located in Odon with plenty of parking.

PONDEROSA STEAKHOUSE

Ponderosa Steakhouse, 5 Cumberland Drive, Washington, where you will find good food and casual family dining. They serve up all-American favorites and something-for-everyone on a full buffet, featuring a variety of dishes including beef, chicken, seafood, sides along with an expansive fresh vegetables and fruit, soups, salads, appetizers and desserts. Food can be purchased by weight to go, with catering options available, including their now famous wings and sauces. A meeting room that can seat 125 is available for special occasions at no extra charge.

BAMBINI'S & TOP NOTCH BOUTIQUE

Not sure what your look should be? Bambini's, 218 E. Main St., and Top Notch Boutique, 11 S.E. Third St., both in Downtown Washington, can help you aggregate a style with their special talent for knowing what looks good. Boutique clothing and accessories help you get the modern look at both an affordable price and personal shopping experience. ▼



[AGRICULTURE & INDUSTRY]

While some communities might have all their employment eggs invested in a single company or industry in Daviess County the basket is full of companies that range from value added agricultural operations, to historical heavy industry, to companies involved in the modern defense industry.

AGRICULTURE

Agriculture is a major player in the local economy and also in terms of jobs. Perdue Farms provides an estimated 1,000 jobs in the area. The company is vertically designed in southwestern Indiana and in Daviess County includes a large feed mill, grow-out contract farms, plus hundreds of jobs in the turkey processing plant.

Another value-added business making a difference in the Daviess County economy is Grain

Processing Corporation. The company operates a major wet-mill corn processing operation. It produces everything from corn from alcohol to animal feed. The company employs almost 200 people in Daviess County and is in the process of a major expansion of its MALTRIN operations.

Both GPC and Perdue are major purchasers of corn in southwestern Indiana. Both utilize hundreds of thousands of bushels each year impacting the trucking industry as well as farms.

IMPACT OF THE RAILROAD

When Washington was just beginning to develop over 100 years ago one of the biggest impacts on the town came when the railroad shops opened on the city's west side. Those shops have gone through a lot of changes over the years, but they are still a major part of the local job picture. Two years ago Eagle Railcar

purchased the shops and began to use them to refurbish rail cars. The Washington operation is the first for Eagle in Indiana and in quick fashion the company has gone from zero to 150 workers with even more additions on the horizon.

MINING

Another traditional industry in Daviess County is coal mining. At times the county has had as many as one dozen mines in operation. These days there is one mine in full operation and another that is in the midst of getting started. Both are owned by White Stallion Coal of Evansville and have around 80 workers.

The mines are not the only employers because of coal in Daviess County. Trucking, machinery and support businesses also provide jobs. McAllister Machinery has more than 50 employees providing equipment and support to the coal mines still operating in southern Indiana.

NEWER COMPANIES

Some of the newer companies in Daviess County are also making a big impact. M&C Tech became the first Japanese owner company to open along I-69. The firm makes plastic parts for the auto industry. It is on the way toward hiring as many as 100 people as it expands its shifts.

Another growing neighbor to M&C is Isoflex Packaging. The plastics company has three lines making plastic packaging for industry.

Another plastics operator is Berry



Plastics just outside of Odon. The subsidiary of Evansville-based Berry Plastics has gone through several expansions and makes plastic film for business and industry.



AMISH COMMUNITY

Those modern operations are found alongside several successful businesses in the Daviess County Amish community. K&K Industries, Daviess County Metal, and Graber Post Buildings employ hundreds of people. The companies build trusses and put up buildings all over the eastern half of the United States. Amish work crews totaling more than 100 are working throughout the Midwest with these companies.

The entire area along CR 900E is a growth area for Amish-based business. The county has been participating in a multi-million dollar expansion to allow the trucks that supply the businesses to safely operate with the more than 100

businesses along the roadway that include cabinet shops, sawmills, an auction house, produce center and two large community buildings.

CLOTHING

Daviess County has its own corner of the clothing business. NASCO Industries has around 100 workers turning out outerwear for the oil, utility and energy industries. The employee-owned firm has had so much success it is expanding.

Another clothing company, and again one that has more to do with utility than fashion, is Tri-Star Glove. The Plainville-based business has been in operation since 2001, employs around 50 people and makes gloves for the auto industry.

A DIVERSE MIX

Cornelius Manufacturing, between Elnora and Odon, sits right on I-69. The company makes its uniquely designed Corn-pro trailers there that have become very popular with people moving small numbers of livestock.

Belt Tech Industrial, south of Washington, 1996 S 300 W, serves the coal and power producing companies in the area. Establishing a reputation for quality work, business grew quickly that first year leading to the need for a larger facility to handle an increasing inventory of belting, pulleys, bearings, shafting, etc. Headquartered in Washington, its territory has expanded into multiple

states and now has a focus on the national market.

One thing southern Indiana is known for is the furniture industry and Daviess County has its own little piece of that. Olon Industries has its North American Headquarters in Washington. The company specializes in building drawers for wood furniture.

Northern Daviess County is a mix of Amish-based business and some high-tech operation. Alion Science and Technology built a major operation in the WestGate Technology Park where it repairs equipment for the aviation industry. Applied Logistic Services in Odon provides professional services to Crane, while family-owned Stoll Brothers Lumber has seen growth because of the WestGate @ Crane Tech Park development and its strong work ethic and attention to the details.





ODON PHARMACY

200 West Main St., Odon, IN • www.odonpharmacy.com

COMPLETE PHARMACY SERVICES

Locally owned & operated
Ken Holland P.D.,

636-4600

Lemon Tree

220 E. Main Washington, In

812-674-2165

***We carry Mud Pie, Luca & Danni,
Nora Fleming, Blue Q, Mud Love,
Jelly Cat and much more!***

Store Hours
Monday-Friday: 10 am - 5 pm
Saturday: 10 am - 3 pm; Sunday: Closed

Facebook: Lemon Tree Home Décor
Instagram: Lemontree_homedecor





NSWC AND WESTGATE MAKE GOOD NEIGHBORS

Good neighbors are not hard to find in Daviess County and those in the job market or who are looking for business opportunities may not find a better neighbor than Naval Surface Warfare Center, Crane Division, which is located just across the Daviess County border in Martin County.

NSWC is a high-tech agency that provides support to the U.S. military, primarily the Navy, but also provides technical support for the Naval Air Command, Marine Corps, Special Operations and Air Force. Employees at NSWC ensure our troops are able to operate and maintain equipment designed to help the warfighter complete its mission and return home safely. NSWC Crane is responsible for equipment on virtually every

USN ship and submarine and even provides support for foreign military sales for ally countries such as Australia and Saudi Arabia.

Supporting the warfighter is the number one priority for NSWC's employees, of which about 10 percent are Daviess County residents. NSWC employs about 3,400 people; of whom 73 percent are scientists, engineers and technicians, and 296 are Daviess County residents. They do annual business totaling more than \$1.4 billion. Crane Army Ammunition Activity employs another 800 staffers.

With more than 1 million square feet of offices and laboratories, Crane provides a distinct advantage in sensors, communications, mobility, special munitions and weapons.

Main priorities in the Crane product mix include cybersecurity, hypersonics, trusted electronics, threat modeling, predictive analytics, human systems engineering, artificial intelligence, modeling and simulation.

Daviess County residents employed at NSWC earn approximately \$26.1 million annually. Further, Daviess County businesses account for \$8.2 million in contracts with NSWC.

Businesses interested in doing business with NSWC can participate in the Buy Indiana Days, an event conducted annually at French Lick Resort.

A new multi-county and state agency group, White River Military Coordination Alliance, was formed in 2019 to "aggressively support," long-term economic development and the creation of military value for the nearly 100-square-mile NSA Navy facility, the third largest Navy base in the world.

The base also engages area students, from elementary to college age in promoting career and learning opportunities in STEM, helping more than 6,000 students, and more than 100 teachers in 30 schools in 2018.

WESTGATE TECH PARK

Defense contractors at the WestGate Tech Park support the





Naval Surface Warfare Center Crane Division by providing personnel and physical space needed by the Department of Navy. While the number of employees varies by contract, NSWC Crane Division relies heavily on the contractor support.

Ever-changing U.S. Navy needs are met by about 25 different vendors that include: AECOM, Alion, Artisan Electronics, Battery Innovation Center, BrightVolt, CACI, CJSeto, D2D, DTA, FLIR, General Dynamics, GeoNorth, IODD, Indiana University, JRC, McKeane, Precise Systems, Raydar, SAIC, STIMULUS Engineering, Tri-Star Engineering, University of Louisville; University of Southern Indiana, WestGate Authority, and, WILLCOR.



WESTGATE ACADEMY

Nearby West Gate Academy, a conference and training center at 13598 E. WestGate Drive, focuses on workforce education, government and military contract support, technical transfer and incubation, and conferencing. Its largest room encompasses more than 14,000 square feet of space.

WestGate has partnerships with Purdue and Indiana universities, and offers state-of-the-art facilities with built-in audio-video services, 18 private classrooms, two computer labs, professional catering and on-site parking.

As part of the academy, The Lock & Key, is a co-working space that houses innovators, entrepreneurs, and today's problem solvers. It's an ideal location for the next big idea to become a reality. Consider The Lock & Key when you begin collaborating on your next project, networking with other professionals to discover new opportunities, or individually building your next business venture. Contact Samantha Nelson at sjnelson@prf.org for a tour, membership, or sponsorship opportunities.

WASHINGTON

TIMES HERALD

COMMUNITY NEWS
DIGITAL

**Bringing
your local news and
local ads to you,
WHEREVER YOU
ARE**

**Local Sports • Local News
Local Events
Classifieds • Digital Advertising**

**102 E. VanTrees St., P.O. Box 471, Washington, IN
812-254-0480 • washtimesherald.com**

Neighborhoods



Various subdivisions and housing developments make up neighborhoods in Daviess County, with many choices available – from big and glamorous, to smaller, more affordable and practical.

For someone who wants a piece of land to build, there is room for growth in many of the subdivisions and other land available for development.

Washington has middle- to low-income housing options available in Cherry Tree Apartments on the east side and Westwood Crossing Apartments on the city's west side and various duplexes, and through the Washington Housing Authority with rental options. New to Downtown Washington are several higher-end lofts on the second floor of retail spaces, with stunning details and historic charm. These lofts appeal to many as it puts tenants in close proximity to downtown's popular amenities such as Meredith Plaza, Main Street shopping and eating.

Towns like Montgomery have developed lots in Oakview Heights next to Country Oaks Golf course and Terrace Court just south of the rural town, both offering a bit of country

life, but with neighbors close by in the more than \$250,000 plus range.

Odon, a town of about 1,400, has that small-town feel but with far more amenities, is located about 20 minutes north of Washington, and is in close



Washington has most of the county's population at 36.9 percent, while offering amenities like trash pickup and various Internet options, there are high-end neighborhoods like Green Acres, Alexander Estates, White Ridge Court, Deer Creek, Bean Drive and Piankeshaw Trail.

Less expensive, mid-range homes can be found north of Eastside Park on Park Avenue, Lakeview Drive, Glenwood Drive and Sugarland Road with average three-bedrooms selling for about \$141,000, plus.



proximity to both Interstate 69 and Crane Naval Base. North of Odon next to the base off U.S. 231 is Deerfield subdivision.

Areas near West Boggs Lake also offer neighborhoods near the lake itself as part of South Pointe and Meyers Point, both located east of CR 1200E, better known to locals as St. Mary's Road.

For more information about housing options, contact a Daviess County realtor.



TABER OWENS

CONSTRUCTION GROUP

Full-Service General Contractor/Construction Manager



Our Services

- *Conceptual Budgeting*
- *Value Engineering*
- *Owner's Representation*
- *General Contracting*
- *Construction Management*
- *New Construction*
- *Renovation*

Hospitality

Taber Owens Construction Group has decades of experience in the hospitality industry and has developed relationships with many major lodging companies and franchises such as:

- *Hilton Hotels & Resorts*
- *Marriot Hotel Group*
- *Choice Hotels*
- *InterContinental Hotel Group*
- *Wyndham Hotels & Resorts*



Types of Construction

- *Hospitality*
- *Commercial*
- *Retail*
- *Healthcare*
- *Industrial*
- *Worship Facilities*

www.taberowens.com

1617 West Old Hwy 50, Washington, IN - (812) 254- 1610

DAVIES COUNTY MAP

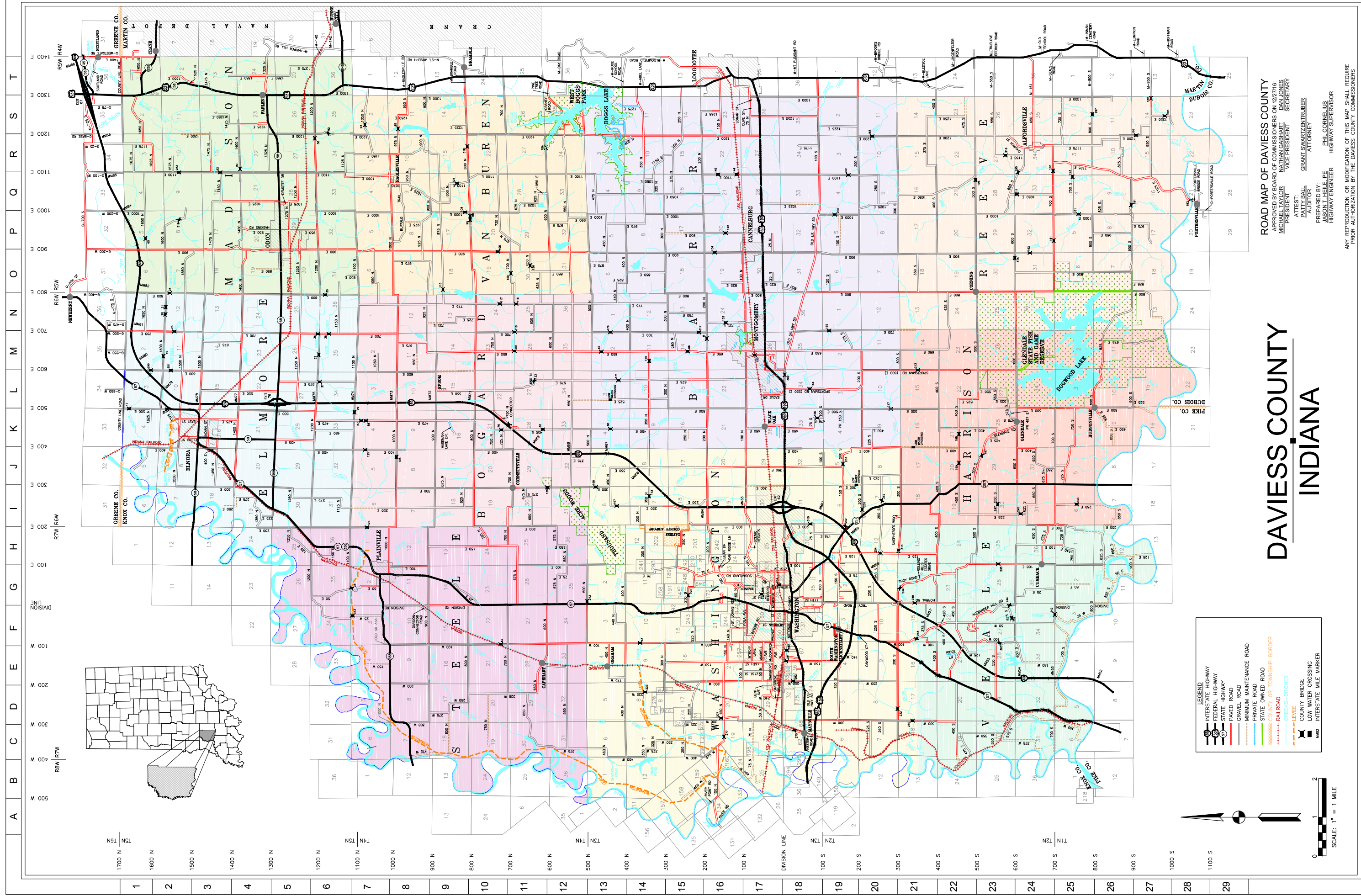

Lodging

Residents, tourists and business personnel find it easy to travel in and out of Daviess County.



The county is accessible by a number of U.S. and state highways, including Interstate 69, U.S. 50, U.S. 231, SR 57 and SR 358.



Daviess County is 260 miles southeast of Chicago, 100 miles south of Indianapolis, 200 miles north of Nashville and 600 miles northwest of Atlanta.

The Daviess County Airport provides service to private and charter aircraft and will also accommodate business jets, and does so routinely. The airport has available jet fuel, AV gas, major/minor repairs and aircraft rentals.



Three major railroads traverse Daviess County, the CSX, the Indiana Southern and the Indiana Railroad in northern Daviess County.

In addition, Washington has city bus service five days a week.



Lodging is available in a variety of hotels, including:

In Montgomery

GASTHOF VILLAGE INN

6747 Gasthof Village Road
Just off CR 650E

In Odon

GRABER GREEN GABLES

8824 N. 900 E
Odon, IN 47562
812-636-4399

In Washington

BAYMONT INN & SUITES

7 Cumberland Drive

BLACK OAK MOTEL

4658 U.S. Highway 50E

BUDGET INN

412 E. South St.

CITY MOTEL

1115 E. National Hwy.

HOLIDAY INN EXPRESS

1808 E. National Hwy.

THEROFF'S MOTEL

2001 E. National Hwy.



At Hometown Hearing, our mission is to help improve each person's quality of life by improving the quality of their hearing. Hometown Hearing Inc.'s goal is to help everyone in Vincennes and the surrounding communities with all their hearing service needs.



Karin Schmidt, BC-HIS
Board Certified
Hearing Instrument Specialists



Tim Schmidt
Co-Owner

CALL TODAY TO SCHEDULE YOUR FREE HEARING EVALUATION!
Vincennes: (812) 882-2075 • Washington: (812) 674-2334

SERVICES OFFERED INCLUDE:

- Comprehensive hearing tests and evaluations for adults
- Full line of hearing aids, specializing in digital hearing aid technology
- Hearing accessories (batteries, custom ear molds, water protection, earplugs, noise protection)

Call today to hear more about our special offers!
We service all makes and models!

Hometown Hearing, Inc. 

Locally Owned and Operated

2003 Hart Street,
Vincennes, IN 47591

(812) 882-2075

420 S. Hwy 57,
Washington, IN 47501

(812) 674-2334

www.HometownHearingInc.com

MONDAY-FRIDAY 9AM-5PM

After hours and Weekends by Appointment only

MARNER

DOOR MANUFACTURING

4254 N. 525 E. - Montgomery, IN 47558
812-486-3128 Fax: 812-486-3247



a family business
supplying top
quality doors to professional
cabinet makers
and individuals *since 1990*

Stolls Woodworking, LLC

Tel: 812-636-4092 Fax: 812-636-7523

8779 N 1025 E • Odon, IN 47562

Quality is Tradition at Stolls

We continue today the old-world work ethic of handing down wood-working skills from generation to generation of craftsmen.

✓ **New Construction** ✓ **Remodels**

✓ **Residential** ✓ **Commercial**

Handcrafted Solid Wood Cabinetry Custom Built to Fit Your Needs.

A family owned and operated business since its beginnings in 1980 now in its third generation.

We are committed to building quality products that are not only uniquely beautiful, but also functional and durable.



Kitchens



**Architectural Ceilings,
Beams & Trusses**



Fireplace Mantles



Bathroom Vanities

eZBanking

easy: eas·y (ē'zē) *adj.*

achieved without great effort; presenting few difficulties.

Meet Your
Washington
Team!



John Clauss
Vice President & Commercial Loan Officer
jclauss@svbt.com



Kandi Thompson
Banking Center Manager
kthompson@svbt.com



Veronica Perez-Cruz
Universal Banker
vperez-cruz@svbt.com



Natalie Smith
Mortgage Loan Officer
nsmith@svbt.com
NMLS #: 1851036

Visit our
Washington
Banking Center
1717 South State
Road 57, Suite A
Washington, IN
47501.

*Loyal to you, your family,
and your future.*



springsvalley

BANK & TRUST COMPANY

svbt.bank | 800.843.4947 | Since 1902



Member FDIC





Family-friendly with
FUN TO SPARE!



Call for **CARRY-OUT!**

2100 State Street, Washington • (812) 254-0632

Have
dinner here!
Celebrate birthdays!
Join a league!

Enjoy our
WORLD
FAMOUS PIZZA
& breadsticks!



"World Famous" **Dinky's Auction Center**

The place to be on Friday evening.

One of the largest consignment auction centers in the U.S.A. 8 to 10 auction rings going at once with thousands of people selling livestock, furniture, appliances, small animals, poultry, machinery, hay, cars, boats, trucks, hand tools, guns & produce.

Auction time is 6pm every Friday, plus other special auctions.
Located 5 miles north of Cannelburg, Indiana just off Highway 50 on CR 900E

812-486-2880



www.dinkysauction.com

Visit www.auctionzip.com

Auction ID# 18776 for listings on special events
GPS Address: CR9073E, CR550N, Montgomery, IN



**CONTACT US
FOR A FREE
QUOTE TODAY!!**



Graber Post Buildings, Inc.
7716 N. 700 E. | Montgomery, IN | 47558
GRABERPOST.COM | (800) 264-5013

YOUR ONE STOP SHOP

FOR ALL YOUR **ROOFING
& BUILDING** NEEDS

TRUSSES | LUMBER

WINDOWS | DOORS

LAMINATED
COLUMNS

STANDING SEAM METAL

CUSTOM METAL TRIMS

METAL PANELS

COMPLETE PACKAGE
DELIVERY



Education



Washington Schools empower students to Imagine, Achieve, and Master skills needed for success in a rapidly changing, diverse and technical society. Furnished with Chrome-books and iPads, the PK-12 educational setting provides students a dynamic technology-integrated curriculum that challenges and focuses them on the competencies they need to graduate and enter the workforce and college.

Believing that active participation is a critical component for student growth, Washington Schools offer a wide range of extra-curricular activities.

The district's four K-6 elementary buildings follow an Indiana State Standards-aligned curriculum in math, English-language arts, science, social studies, and the fine arts with remediation opportunities and a high ability program. Through partnerships with Crane and the Westgate Academy, STEM, computer science, robotics and coding activities are abundant throughout its elementary schools. Students can also enjoy a variety of extra-curricular opportunities including Just Say No, Spell/Math Bowl, Robotics Club and athletics.

Washington Junior High serves students in grades 7-8, while Washington High School's population is grades 9-12. Both schools provide Project Lead the Way coursework such as PLTW Gateway, computer science, pre-engineering, and bio-medical science. WHS's Graduation Pathways offer a variety of educational and vocational opportunities in guiding students towards

college and career readiness. The high school also partners with the Vincennes University Early College Program, allowing students to earn dual-credit in several classes as well as through AP (Advanced Placement) coursework.

WHSB Broadcasting, a student-run radio and television class, allows students to learn by producing athletic and other activity programming for the community to enjoy.



Believing that active participation is a critical component for student growth, Washington Schools offer a wide range of extracurricular activities. From the award-winning choir and band programs to a strong state and national represen-





BARR-REEVE COMMUNITY SCHOOLS

DEDICATED STAFF ~ ENGAGED STUDENTS ~ INVOLVED PARENTS ~ DEVOTED COMMUNITY

"HOME OF THE VIKINGS"

We believe in challenging our students, thinking outside the box, and fostering innovative thinkers. The way we challenge the status quo is providing engaging, inquiry-based experiences; advanced rigor; and passionate climate and culture to deliver the highest quality college and career ready educational experience where innovative thinkers are born.



Rich Tradition of Academic Excellence

- **Great Student-Teacher Ratio of 18:1**
- **Indiana Department of Education "4-Star School" for 7 consecutive years**
- **Named National Blue Ribbon School in 2017**
- **Indiana Department of Education Recognition for Digital Learning**
- **High Student Standardized Test Scores - Consistently in the State's 95th Percentile**
- **High Graduation Rate - Consistently above 95%**
- **High Student Attendance Rate - Consistently above 97%**
- **AP and College Dual Credit Programs**
- **Indiana Department of Education Top Performing School District**

Rich Tradition of Athletic Excellence



- **13 Highly Competitive Athletic Programs: Boys Baseball; Boys/Girls Basketball; Boys/Girls Cross Country; Boys/Girls Golf; Girls Softball; Boys/Girls Tennis; Boys/Girls Track & Girls Volleyball**
- **3 Class A State Champions (2 Volleyball and 1 Boys Basketball)**
- **Class A State Finalist 11 Times; (4 in Volleyball, 5 in Boys Basketball, 1 in Girls Basketball, & 1 in Baseball)**
- **1 Non-Class State Finalists in Boys Cross Country**
- **64 IHSAA Sectional Championships**



tation in organizations such as BPA, DECA, and BETA, students are able to connect, explore, and expand their world. The NJROTC program not only develops citizenship and leadership, it encourages community involvement.

The high school is home to one of the nation's largest high school gymnasiums. The "Hatchet House," with a seating capacity of 7,090, imparts the quintessential Hoosier Hysteria atmosphere, hosting sectional, regional and semi-state games. In addition to multiple boys' basketball state championships, Hall of Fame winners, and Mr. Basketballs, the community can boast of post-season successes across multiple other sports -- football, baseball, softball, cross country, track and field, tennis, golf, soccer and wrestling. Hatchet Pride is abundant in our schools and in our community!

NORTH DAVIESS

North Daviess Community Schools is located in northern Daviess County. ND's goal is for all students regardless of income or family background, to have access to 21st Century tools for use at both school and home. The North Daviess model allows each student in grades 1-12 to have a laptop computer that they use at school and home. The objective is to bring about a transformation in the way instruction is delivered. ND believes that ever-present access to technology opens the door to a great

deal of project-oriented learning that is not possible in a traditional environment.

North Daviess Elementary is located adjacent to the high school. Elementary enrollment is about 700 students in 30 classrooms in grades kindergarten through sixth. Outdoor facilities include three play areas, a grass game field, basketball courts, tennis courts, softball field and baseball field.

Every teacher and paraprofessional at NDE is highly qualified. Teachers are dedicated to individual student growth and employ data-driven instruction on a daily basis. Multi-tiered systems of support and dyslexia interventions are embraced as well as best-practice instructional strategies are utilized, guaranteeing differentiation. In addition to the Indiana Academic Standards, the elementary also offers high ability curriculum, Title I services for at-risk learners, resource support for students with special needs, and a robust K-6 STEM curriculum which includes a robotics team. NDE also has an active Parent-Teacher organization and Just Say No club.

North Daviess Jr.-Sr. High School serves students grades 7-12. Enrollment is about 490 students. The members of NDJ/SHS community are committed to developing lifelong learners who contribute positively to the global society by possessing critical thinking skills as well as high moral and ethical standards. This goal will be achieved

by providing the highest standard of educational opportunity in a safe, nurturing and 21st Century learning environment developed in an atmosphere of trust, respect and responsibility. ND's 21st Century learning approach prepares students for the global society of tomorrow through the use of project-based learning (PBL). North Daviess has created a professional culture for its staff and students in a learning-outcomes based environment which focuses on a vigorous PBL approach with emphasis on presentation skills, work ethic/collaboration, technology literacy, critical thinking and citizenship.

The North Daviess model allows each student in grades 1-12 to have a laptop computer that they use at school and home.

Also, the high school has partnered with Oakland City University for an Early College and Dual Credit program which allows ND students the opportunity to earn an associate's degree from Oakland City University while enrolled at ND.



NORTH DAVIESS

Community Schools

"Educating the Leaders of Tomorrow"

5494 E. State Road 58, Elnora, IN 47529

Phone 812-636-8000 Fax 812-636-7546 www.ndaviess.k12.in.us



The North Daviess Community School Corporation, in partnership with the community, will provide optimum educational opportunities for all students to grow and develop into conscientious and productive citizens. This goal will be achieved by providing the highest standard of educational opportunity in a safe 21st Century learning environment developed in an atmosphere of trust, respect, and responsibility.





Students may also earn college credits from Vincennes University, Ball State and Ivy Tech via the dual credit program.

The North Daviess campus is the center of the community activities throughout the year. In addition to community youth football, softball, and baseball, ND offers the students the opportunity to participate in several co-curricular activities, clubs, and sports, including football, basketball, softball, baseball, track, cross country, volleyball, art club, drama club, foreign language club, science club, a robotics team, vocal/instrumental music, and a communications class. North Daviess Community Schools partner with Crane Westgate on several initiatives and receive excellent support from parents, community and local businesses.

The Indiana Department of Education and the Office of School Accountability & Accreditation has honored North Daviess Community Schools for its 2016-17 A-F school performance. NDCSC was rated as an "A" and received the status of a

Performance Qualified School District for the 2018-19 school year.

BARR-REEVE

Barr-Reeve Community Schools is a small, rural school with large accomplishments and high expectations. The district of 921 students with a student-teacher ratio of 18 to 1 has been recognized by the Indiana Department of Education as a "Four-Star" school for seven consecutive years and also continues to be named a Top Performing School District.

It was named a National Blue Ribbon school in 2017 and is consistently among the top achieving schools in the state for both academics and athletics.

Barr-Reeve is also recognized by the Indiana Department of Education as a district leading the way in digital learning and having a strong vision for STEM education. Barr-Reeve is a two-time recipient of the Digital Learning Grant by the Indiana Department of Education, one of 14 corporations to receive the STEM Acceleration Grant

during the 2018-19 school year, and established its STEM Academy in 2018. The district went 1:1 in 2016 by providing every kindergarten student with an iPad and all students in grades 1-12 with Chromebooks. Students receive a blended learning experience enriched with engaging, inquiry-based experiences; advanced rigor; and the highest quality college and career ready educational experiences.

The district is embarking upon a \$12 million renovation project as a K-12 solution to move all students to one campus, accommodate growth, modernize athletic and fine arts spaces (which serve students in grades K-12), and begin the process of designing advanced science lab spaces.

Barr-Reeve's graduation rate is consistently above 95 percent and has topped out at 100 percent more than once. Attendance is also consistently above 97 percent. Students at Barr-Reeve have high standardized test scores, routinely in the state's 95th percentile, and very few discipline issues.

The Vikings, ranked as Class A by the Indiana High School Athletic Association, has a rich tradition of excellence in athletics with 13 highly competitive athletic programs for both boys and girls.

Academic teams also compete in spelling, mathematics, science, social studies, English and fine arts.



Barr-Reeve's graduation rate is consistently above 95 percent and has topped out at 100 percent more than once.



Various co-curricular activities and clubs are available to Barr-Reeve students across the district including BETA Club, Student Renaissance, Student Council, SADD, FCCLA, Just Say No, and two STEM Clubs. Seniors take an annual trip to Washington, D.C. and New York City, the Foreign Language/Arts Department takes a trip to Europe once every four years, and band members have the opportunity to travel to both Chicago and Disney World once during their high school career.

As support of committing to the futures of its students, Barr-Reeve offers two unique scholarship opportunities for its students. Established in 1988 by Charles

A. Kavanaugh, along with other teachers and administrators, the citizens of the Barr-Reeve community came together to establish the Barr-Reeve Scholarship Foundation with an endowment of more than \$500,000, which makes scholarships available to graduating Barr-Reeve seniors. Starting with the Class of 2031, the Kendall Murphy Scholarship provides \$100 towards

Washington Catholic School has a balance of religious education, academic study, worship and physical activity.

a College Choice 529 plan for incoming kindergarten students.

Barr-Reeve Community Schools, known as "Home of the Vikings," is also home to a dedicated staff, engaged students, involved parents, and a devoted community. It takes more to be a Viking!

WASHINGTON CATHOLIC

Since 1837, Washington Catholic Schools has been dedicated to maintaining the highest caliber of academic excellence within a context of caring, Christian environment.

The school has a balance of religious education, academic study, worship and physical activity.

There are classes for preschool



WASHINGTON CATHOLIC SCHOOLS

Education for Life, Faith for Living

***Christian Education**

***Academic Excellence**

***Family Atmosphere**

Opportunities at Washington Catholic are available from Pre-school through 12th Grade.

WC also offers before and after school child care.

For more information or to schedule a tour please call 812-254-2883.

through 12th grade. WC has qualified, dedicated teachers with discipline in the classroom, low ab-

senteism, parental involvement, diverse extracurricular activities and strong state and national test scores.

PLEASANTVIEW CHRISTIAN DAY SCHOOL

Set in rural Montgomery, Pleasantview Christian Day School, on CR 200N, had its beginnings in 1967, as an outreach ministry of Pleasant View Mennonite Church. Its school board supervises the overall direction of the school and its programs, sets school policy and administers the school. Pleasantview Christian welcomes families who are willing to support the school and recognize that the school is founded on Christ and His teachings.

The school's mission is to provide a Christ-centered education with academic excellence, moral integrity, and spiritual depth, which will prepare students to follow Christ in life.

The education at Pleasantview is based on ACE Curriculum and the school offers education grades K-12.

Pleasantville Christian Day School's mission is to provide a Christ-centered education with academic excellence, moral integrity, and spiritual depth.

FAMILIES FIRST HOME EDUCATORS

Families First Home Educators offers an alternative to traditional public or private school, by offering encouragement, support and opportunities for home-educating families in Daviess County. FFHE is parent-directed, home-based, and privately funded.

The organization provides sports, field trips, physical education, drama, workshops and other opportunities. FFHE offers a 12-week co-op which provides enrichment classes in fall and spring semesters for students age 2 through high school. The number of families using FFHE locally has grown each year and now numbers more than 65 families.

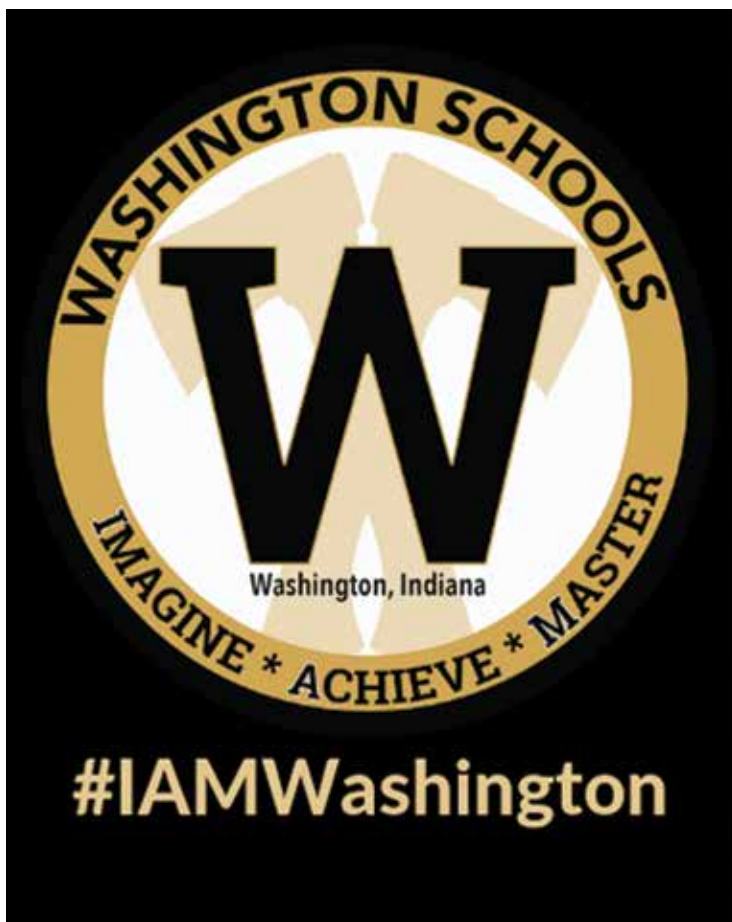

**Washington Schools
empower students to
Imagine, Achieve, and
Master skills needed
for success in a rapidly
changing, diverse, and
technical society.**

www.washingtoncommunityschools.org

GASTHOF AMISH VILLAGE

—Visit us. Step into our world. A quieter, simpler world. Filled with homemade food, gifts, and blessings. Bring your family. Stay for the day. Enjoy life at a slower pace.

- Gasthof Restaurant
- Bakery • 82-Room Village Inn
- Unique Shops
- Flea Market
(1st Weekend April-November)
- Meeting & Banquet Facilities
- Catering



Open 7 Days a week

6659 E. Gasthof Village Rd.
Montgomery, IN
812-486-4900
www.gasthofamishvillage.com



Cullen Medical Professionals

Now Accepting New Patients!

Office Hours

Monday - Thursday
8 a.m. to 7 p.m.

Friday
8 a.m. to 5 p.m.

Closed every day 11:30 a.m. to 12:30 p.m.

Cullen Medical Professionals also offers visiting specialties in Cardiology, Otolaryngology, Orthopedic Surgery and Podiatry.



Good Samaritan
Physician Network

2005 State Street | Suite A
Washington, IN 47501
812-254-4650



Custom Cabinets & Furniture LLC

Norman K. Graber

*Custom cabinetry thru out
the whole house*

*New showroom floor with
dining room furniture!*

Ph: (812) 486-2503

Fax: (812) 486-2703

8766 E. 450 N.

Montgomery, IN 47558



[THINGS TO SEE & DO]

If you're visiting or planning to call us home, there are plenty of things to see and do in Daviess County. There are parks and lakes for picnicking, boating, fishing and hunting, golf (pro-courses and mini-golf), as well as a large Amish settlement, and a jackpot drawing that attracts thousands.

WASHINGTON COUNTRY CLUB

The Washington Country Club, 908 Bedford Road, is a nine-hole course that offers elevation changes.

Playing between 4,920 and 5,366 yards, the course features two of the more difficult par threes in the area. The course, with many narrow fairways, is challenging but fun for amateurs and pros alike.

Yearly memberships are available, but the course is open to the public. The Country Club is also available for outings.

Leagues are held for men and women.

Inside the club, Aces Restaurant is open daily for dining. Soft drinks and beer are available. Additional adult beverages are served at Aces Restaurant, where you will find live entertainment almost every Saturday night.



COUNTRY OAKS

Country Oaks, located on U.S. 50 one mile west of Montgomery, offers five teeing areas that stretch the 18-hole course from 4,983 to 6,966 yards.

A driving range is offered and used for lessons from Trey Miller, general manager.

A well-stocked pro shop offers equipment and soft goods. The property's old home is used for private parties and gatherings.

Sandwiches and hot dogs are available, as well as a variety of snacks and soft drinks.

Season passes may be purchased. The course is open to the public and is available for outings.

Leagues are held for men and women and many high school matches are played there..

WEST BOGGS

West Boggs Park spreads across 1,500 acres in Daviess and Martin counties. The lake itself is 622 acres, with the main entrance located on SR 231 north of Loogootee.

Boating, fishing and camping are main attractions at the park.

The park offers a laid-back type of atmosphere and encourages the usage of personal golf carts to make the facility more accessible to all ages.

Park programming offers different events each weekend, featuring activities in forestry, water or boating. Boats of all sizes are generally welcome, with a 35 mile-per-hour limit set. Skiing and jet skiing are also a feature on the lake.

Stoll's Lakeview Restaurant and Lakeview Golf Course are also park attractions. Both entities are operated privately.

Water fowl hunting is encouraged during season. The park also has areas available

for general hunting during appropriate seasons.

Campsites are available for year-round camping. The park is closed to non-campers from 10 p.m. until 5 a.m. Park facility usage is possible during the hours with permission of park officials.

Additional information is available by calling 812-295-3421, or by accessing the park's website at westboggs.com.

PUTTER'S BAY MINI GOLF

Putter's Bay is an 18-hole layout playing to a par 42. Located at 1 Putter's Bay, it offers play from early spring through late fall depending upon weather.

Individual game prices vary by age, with persons ages 3 and under free.

The facility welcomes groups, parties and fundraisers along with the public, and was designed without steps or stairs for the handicapped. Putter's Bay offers three four-week leagues starting in June and ending in August. Participants play Monday through Thursday, with scores posted weekly. The course also serves as host for the Midwest Mini-Golf Championship held annually in October.

In season, the facility opens weekdays from 5 until 10 p.m. school days. When school is not in session, hours are noon until 11 p.m. Putter's opens weekends noon until 10 p.m.



WATERWORLD

The city's pool is a multi-use water facility. It features a three-flume water slide, a zero depth entry pool, a splash pad, a children's pool slide and several other features.

WaterWorld is open the day after the local schools close in May, and closes the day before classes begin in the fall.

Normal operating hours are 10:30 a.m. until 7 p.m. Monday through Thursday, 10:30 a.m. until 6 p.m. Friday. The facility is open 12:30 p.m. until 6 p.m. Saturday and 1-6 p.m. Sunday. It is available for private parties after hours.

KINGPIN BOWLING CENTER

Kingpin Bowling Center is a 24-lane family recreation center located at 2100 E. State St, Washington..

The facility hosts leagues throughout the year for men, women and youth, and is also open to the public for open bowling.

Equipment and ball repair are available

at the pro shop. King Pin Bowling has a recreation area, pool table, food counter featuring a variety of foods and soft drinks, including its now-famous pizza, a bar serving beer and wine coolers and a party room.

Kingpin Bowling may be booked for parties. The entire center may be rented on a per-hour basis.

KNIGHTS OF COLUMBUS JACKPOT DRAWING

A game of chance with cash payouts ranging from \$250,000 and pots can top \$2 million, in Downtown

Washington, crowds gather every Saturday evening from late April to late fall, depending on how many weeks it takes to get a jackpot winner.

Multiple huge 50/50 pots are drawn, and there is a beer garden and multiple vendors. Crowds have topped 8,000, including local residents and visitors from all over the Midwest.

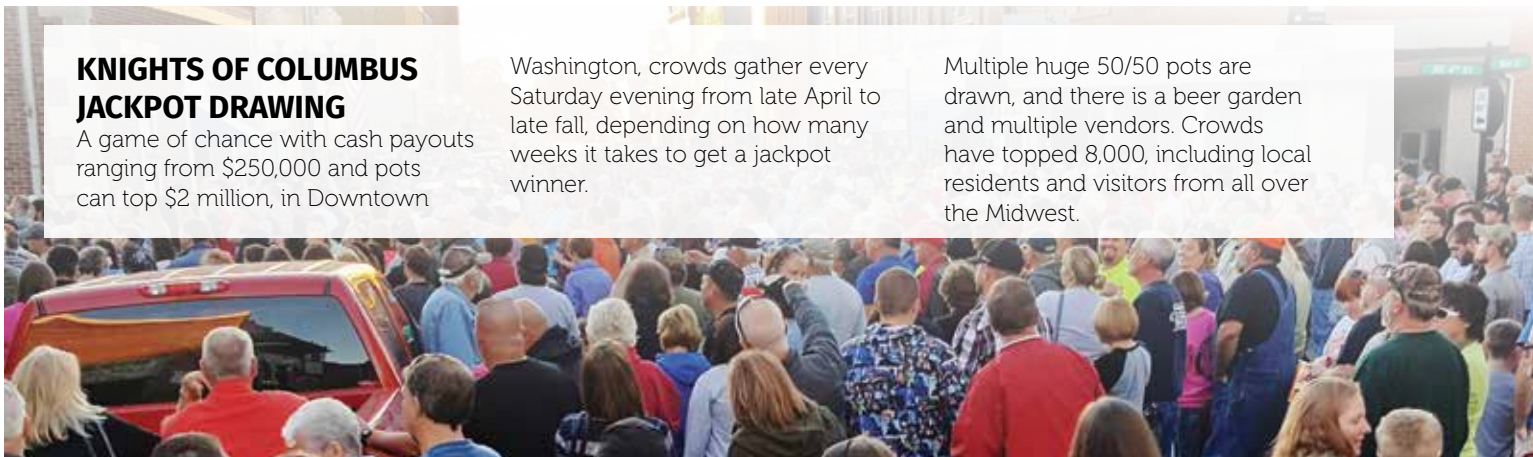



DAVIESS COUNTY MUSEUM

The Daviess County Museum is the home of local history in the Daviess County area. Located at 212 E. Main in Washington, the museum chronicles the centuries of people, places, and events that narrate the story of our local community through exciting exhibits, engaging events and extensive archives.

A dedicated team of volunteers curates four floors of exhibit space guiding visitors on a unique journey through the social, cultural, and economic development of our county from prehistory to the frontier and into the present, while the museum's interactive digital media exhibit

transforms learning into the familiar realm of contemporary technology.

Museum events bring history to the public with a range of programs for all ages including guest speakers, the monthly Kids Klub and the History Scholar badge. The new Daviess County Research Room available Wednesday and Saturday hosts the museum's document archive with hundreds of resources for genealogists and other curiosity-seekers. The museum is open Wednesday through Saturday from 11 a.m. to 4 p.m., with special group tours available by appointment. For more information call (812) 257-0301 or visit www.daviesscountyhistory.com.

SCREEN GLOW ARCADE

With more than 300 video games, it's a safe, fun place for kids and kids at heart. No quarters are required. Pay per hour or get a daily rate. Located in Downtown Washington at 402 E. Main St.

WASHINGTON CITY PARKS AND POOL

Washington offers a variety of activities year round in its park and water facilities.

Eastside Park is the city's flagship park. It has open shelters to go with a large screened pavilion and enclosed community building. Both of the larger buildings can be rented by individuals or groups.

Fishing is also available at the two lakes within the park. Boats are allowed, and may have trolling motors.

Several miles of paved surfaces are used for walking or running. Basketball courts and a large playground area are

also offered.

The park hosts a youth fishing tournament in June, a Fourth of July celebration, summer fun in the park and Christmas in the Park — one of Indiana's best light displays.

Six tennis courts and a playground are included at the Washington Sports Complex on Edwardsport Road. Long-

fellow Park has a skate park for boarders to go with a softball field, a walk/run exercise station path, basketball goals and a playground.

South Park offers a playground, basketball goals, softball field, tee-ball field and soccer field.

Parks are open from 7 a.m. until 11 p.m. throughout the year.



***"The area's premier John Deere dealer.
On Hwy 57 between Newberry and Elnora."***



Hutson

7362 S. State Rd. 57, Elnora, IN / 812-659-2101
www.HutsonInc.com



**Mary Roark,
Owner/Broker**



Midwest Realty
Celebrating over 45 years

1704 E. National Hwy, Washington, IN 47501
Office: 812-254-3918; Cell: 812-486-6363

Fax: 812-254-3922

midwestrealty47501@gmail.com

maryi47501@yahoo.com

midwestrealty.net

SERVING WASHINGTON AND SURROUNDING AREAS!

ODON PARK

The Town of Odon Parks and Recreation Department provides park facilities to accommodate the needs and interests of local residents and visitors. Whether you are into sports, nature or just want to take your children to a nice playground, the Town of Odon has a place for you.

The park facilities are available to groups and citizens to reserve for family gatherings, group parties, picnics, meetings, or other events. There are shelters, a floral hall and full-service community building.

Park reservations are on a first-come, first-serve basis and a fee is required. For additional information or to see if a specific date is available, contact the Odon Town Hall at 812-636-4321.



AMISH SETTLEMENT

Daviess County has made its mark on Amish tourism, with three Amish buffet-style restaurants, horse and machinery sales at Dinky Auction Center several times a year, and at least two quilt shows, plus the Daviess County Relief Sale set in the rural

Amish-Mennonite community.

Several small shops dot the countryside, with quilt materials, bulk foods, hand-crafted furniture and cabinets, homemade candy and jellies, cheeses, meats and baked goods.

Amish tours are available.



GLENDALE FISH AND WILDLIFE AREA

Glendale Fish and Wildlife Area offers 8,062 acres for hunting and camping. Within that area is a 1,400-acre lake for fishing.

The facility, operated as part of the Indiana Department Division of Wildlife and Fishing, is open year round.

Fishing is always a popular activity for area residents and tourists. Boats are limited to 10 miles per hour while on the lake, which opened in 1967.

Class A and B camping areas are also popular. Camping on the 121 sites are

first-come, first-serve. Class A areas include electrical hookups, with shower and bathroom facilities available for all campers.

Glendale is also popular for hunting. Squirrel, dove, rabbit, quail, deer, turkey, pheasant and water fowl are game at the facility. Pheasant hunting is normally defined by limited days and numbers of hunters allowed. Other game is in season.

Hours of operation are dependent upon activities and time of year. For additional information concerning activities at Glendale, phone 812-644-7711.

MONTGOMERY RURITAN PARK

Home to the Montgomery Turkey Trot Festival, the weekend after Labor Day, this park has played host to top-notch entertainers since 1972.

Several major improvements and expansions have been made to the festival grounds and campground areas in recent years.

The campground with its modern facilities and many trees continues to attract hundreds of campers from Southwestern Indiana and from more distant places each year. With the recent completion of several new shoreline campsites, Montgomery Ruritan Park and Campgrounds has more than 120 campsites available during the camping season of mid-April through mid-October each year, and most are booked on an annual basis. Service to the community has been the major theme of the Montgomery Ruritan Club.

[DAVIESS COUNTY MEMBER DIRECTORY]

Advertising

BACKROADS ADVERTISING, INC.

202 S.E. Fourth St.
Washington, IN 47501
812-259-2955

LAMAR ADVERTISING

4701 E. Margaret Drive
Terre Haute, IN 47803
800-729-9448

SCHOOL COURIER

3802 E. Second St.
Bloomington, IN 47401

Agricultural Equipment

BLESCH BROS. EQUIPMENT CO. INC.

8250 E. SR 58
Odon, IN 47562
812-636-4050

FARMERS STORAGE SUPPLY

5721 E. Hwy. 50
Montgomery, IN 47558
812-486-3246

MEMERING FARMS

3876 N. SR 57
Washington, IN 47501
812-254-8170

TRAYLOR AG SALES, INC./TRUCK ACCESSORIES

1351 N. 100 W
Washington, IN 47501
812-486-7226

DC FARM BUREAU

443 S. SR 57
Washington, IN 47501
812-254-3514

Antiques

CHANDELIER BARN MARKET, LLC

5060 E. 350 N
Montgomery, IN 47558
812-486-7745

WHITE RIVER VALLEY ANTIQUE ASSOCIATION

534 E. SR 57
Elnora, IN 47529
812-875-3398

Arcade

SCREEN GLOW ARCADE

402 E. Main St.
Washington, IN 47501
812-617-1361

Assisted Living

EMERALD PLACE

297 S. 100 E
Washington, IN 47501
812-254-5230

THE LEGENDS

1764 Troy Rd.
Washington, IN 47501
812-254-9500

PARKVIEW VILLAGE CHRISTIAN COMMUNITY

800 S. West St.
Odon, IN 47562
812-636-3000

PRAIRIE VILLAGE NURSING & REHAB

801 S. SR 57
Washington, IN 47501
812-254-4516

THE VILLAGES AT OAKRIDGE

1694 Troy Road
Washington, IN 47501
812-254-3800

Auction House

DINKY'S AUCTION CENTER

7464 E. 400 N
Montgomery, IN 47558
812-486-2880

GRABER AUCTIONS LLC

1382 S. SR 257
Washington, IN 47501
912-254-2220

Auto Repair

WAGLER AUTOMOTIVE, INC.

6276 E. 1000 N
Odon, IN 47562
812-636-8177

Bakery, Food

THE BAKERY HOUSE

406 S.W. Second St.
Washington, IN 47501
812-257-1111

Board Horses, Riding Arena

WASHINGTON SADDLE CLUB

1215 Cosby Road
Washington, IN 47501
812-582-9564

Cabinet Making

CUSTOM CABINETS & FURNITURE LLC

4578 N. 875 E
Montgomery, IN 47558
812-486-2503

G & R WOODWORKING, LLC

7747 N. 775 E
Montgomery, IN 47558
812-687-7701

KEMP CABINETS LLC

3590 N. 700 E
Montgomery, IN 47558
812-486-3325

MARNER DOOR MFG.

4254 N. 525 E
Montgomery, IN 47558
812-486-3128

P R BEAN CO., LLC

1191 E. 200 N
Washington, IN 47501
812-254-3761

STOLL'S WOODWORKING, LLC

8779 N. 1025 E
Odon, IN 47562
812-636-4092

Camping, Recreation

GLENDAL FISH AND WILDLIFE AREA

6001 E. 600 S
Montgomery, IN 47558
812-644-7711

WEST BOGGS PARK

16117 US-231
Loogootee, IN 47553
812-295-3537

MONTGOMERY RURITAN CLUB

6907 Park Road
Montgomery, IN 47558
812-486-3742

Car Dealer

BILL DOBSON FORD

15 S. Meridian St.
Washington, IN 47501
812-254-3673

UEBELHOR & SONS, INC.

P.O. Box 630
Jasper, IN 47546
812-482-2222



**UEBELHOR BUICK
GMC CADILLAC**
626 Kimmel Road
Vincennes, IN 47591
812-882-5574

**WASHINGTON
CHRYSLER CENTER**
105 E. Van Trees St.
Washington, IN 47501
812-254-3217

Car Repair/Towing

BIG O TIRES
203 S.E. Third St.
Washington, IN 47501
812-254-3001

**COUNTRYSIDE
TOWING & ROAD
SERVICE**
2430 E. National Hwy.
Washington, IN 47501
812-254-5414

**CRANEY'S BODY
SHOP, INC.**
3031 E. 150 S
Washington, IN 47501
812-254-6412

**DONALDSON
& SELLERS
PROFESSIONAL
AUTOMOTIVE SERVICE**
201 E. South St.
Washington, IN 47501
812-254-2277

NAPA
14 S. SR 57
Washington, IN 47501
812-254-2540

Catering

M&M CREATIONS
2 S.E. 11th St.
Washington, IN 47501
812-881-8368

Cleaning Service

**SERVICEMASTER
CLEAN**
P.O. Box 269
Washington, IN 47501
812-254-6672

**SERVPRO OF
VINCENNES**
712 Upper 11th St.
Vincennes, IN 47591
812-895-0581

CERTIFIED CLEANING
2 W. Main St.
Washington, IN 47501
812-254-9713

Coffee Shop

**CHERRY GHOST
COFFEE HOUSE**
424 E. Main St.
Washington, IN 47501
812-259-2944

Construction

**ABK FLOORING/LRG
CONSTRUCTION**
9040 E. 600 N
Montgomery, IN 47558
812-486-9846

B & D ELECTRIC, INC.
413 W. Van Trees St.
Washington, IN 47501
812-254-2122

**COUNTY WIDE
CONSTRUCTION**
P.O. Box 226
Washington, IN 47501
812-254-7272

**DARRELL O'BRIAN
CONSTRUCTION**
613 S. Meridian St.
Washington, IN 47501
912-254-6796

**DEWAYNE WAGLER &
SONS, LLC**
7803 E. 1000 N
Odon, IN 47562
812-636-4499

**GRABER BROS.
CONSTRUCTION**
9464 E. 200 N
Loogootee, IN 47553
812-254-8011

**GRABER
CONSTRUCTION &
CRANE SERVICE**
151 N. 350 E
Washington, IN 47501
812-254-6202

GRABER CREWS LLC
7716 N. 900 E
Montgomery, IN 47558
812-636-7355

**GRABER POST
BUILDINGS**
7716 N. 900 E
Montgomery, IN 47558
812-636-7355

**HOOVER
CONSTRUCTION**
203 S.E. Second St.
Washington, IN 47501
812-254-3320

J & L HOME CENTER
4608 E. U.S. Hwy. 50
Washington, IN 47501
812-486-3380

K & K INDUSTRIES
8518 E. 550 N
Montgomery, IN 47558
812-486-3281

**KWK CONSTRUCTION,
LLC**
8541 E. 500 N
Montgomery, IN 47558
812-486-9566

**K R L CONSTRUCTION
LLC**
10395 E. 200 N
Loogootee, IN 47553
812-709-9090

**LENGACHER
MASONRY, INC.**
5756 E. Old US Hwy. 50
Montgomery, IN 47558
812-486-3792

**M KEMP
CONSTRUCTION**
9632 E. 600 N
Loogootee, IN 47553
812-486-7187

MARVIN GRABER JR.
11514 N. 1100 E
Odon, IN 47562
812-709-1192



PHILLIP STOLL AND SONS CONSTRUCTION
8365 E. 800 N
Montgomery, IN 47558
812-486-9830

RESCOM MANAGEMENT SYSTEMS, INC.
350 W. 450 S
Washington, IN 47501
812-254-5641

ROGERS GROUP, INC.
2944 E. Covenant Drive
Bloomington, IN 47401
812-332-6341

ROLLIN MINI BARNs PTR, LLC
6950 E. 800 N
Odon, IN 47562
812-687-7581

TABER OWENS
1617 W. Old Hwy. 50
Washington, IN 47501
812-254-1610

VK CONSTRUCTION, LLC
8 N.E. 21st St.
Washington, IN 47501
812-486-6448

W & G CONSTRUCTION
8811 N. 1025 E
Odon, IN 47562
812-787-0078

WAGLER & GRABER CONSTRUCTION, LLC
10547 E. 725 N
Montgomery, IN 47558
812-486-8067

WITTMER CRANE, INC.
19419 N. 1300 E
Loogootee, IN 47553
812-486-5507

Construction, Concrete

A & D CONSTRUCTION
8005 E. 925 N
Odon, IN 47562
812-636-4991

IMI SOUTHWEST
611 W. Main St.
Washington, IN 47501
812-632-0172

JJ'S CONCRETE CONSTRUCTION, LLC
9149 E. 800 N
Montgomery, IN 47558
812-636-0173

JONES & SONS INC.
1262 SR 57S
Washington, IN 47501
812-254-4731

Construction, Electric, Heating, Air Conditioning

KNEPP'S ELECTRIC
13521 N. 1100 E
Odon, IN 47562
812-636-4736

Construction, Residential

JOE KEMP CONSTRUCTION
5458 N. 1200 E
Loogootee, IN 47553
812-486-8558

Construction, Retail

STOLL BROS. LUMBER, INC.
509 S. East St.
Odon, IN 47562
812-636-4053

Counseling, Health Care

WHITE STONE COUNSELING, LLC
2008 Memorial Ave.
Washington, IN 47501
812-674-2000

Consulting, Manufacturing

FRESH START TRAINING CENTER
113 N. Industrial Park Road
Washington, IN 47501
812-254-3399

CPA

KEMPER CPA GROUP LLP
414 S. SR 57
Washington, IN 47501
812-254-0938

PARSONS & ASSOCIATES
3 Sullivan Drive
Washington, IN 47501
812-254-1623

STERLING & COMPANY P.C.
324 E. Main St.
Washington, IN 47501
812-254-1138

Custom Woodworking

HICKORY VALLEY WOODWORKING, LLC
10432 E. 625 N
Loogootee, IN 47553
812-486-2857

Dental, Health Care

DARRELL C. DEEM DDS
100 W. Van Trees St.
Washington, IN 47501
812-254-7550

DR. KIMBERLY WAGLER PARSONS, DS
2 E. Walnut St.
Washington, IN 47501
812-254-4684

LANA R. HELMS, DDS, MSD, PC
2116 State St.
Washington, IN 47501
812-254-4500

DR. MICHAEL WALKER, DDS
2007 Memorial Ave.
Washington, IN 47501
812-257-1223

Disposal

REPUBLIC SERVICES INC.
12820 Commsville Road
Pimento, IN 47866
812-891-9682

Distributor, Private, Services

BELT TECH INDUSTRIAL, INC.
2574 E. 700 S
Washington, IN 47501
812-644-7623

Distributor

INDIANA SAFETY & SUPPLY CO., INC.
1001 N.E. Third St.
Washington, IN 47501
812-257-0499

Distributor, Computer Products

HP PRODUCTS/ FERGUSON FACILITIES SUPPLY
4220 Saguaro Trail
Indianapolis, IN 46268
800-382-5326

Education

BARR-REEVE COMMUNITY SCHOOLS
627 Third St.
Montgomery, IN 47558
812-486-3220



JUNIOR ACHIEVEMENT OF SOUTHWESTERN INDIANA

431 E. Diamond Ave.
Evansville, IN 47711
812-425-8152

NORTH DAVIESS COMMUNITY SCHOOLS

5494 E. SR 58
Elnora, IN 47529
812-636-8000

WASHINGTON COMMUNITY SCHOOLS

301 E. South St.
Washington, IN 47501
812-254-5536

WASHINGTON CATHOLIC SCHOOLS

201 N.E. Second St.
Washington, IN

Education, Public Library

THE CARNEGIE PUBLIC LIBRARY

300 W. Main St.
Washington, IN 47501
812-254-4586

Employment

VINCENNES UNIVERSITY WORKONE

308 W. National Hwy.
Washington, IN 47501
812-254-7734

Event Venue

WESTGATE AT CRANE

13598 E. Westgate Drive
Odon, IN 47562
812-863-4080

Excavating, Construction

DON GRESS CONSTRUCTION

200 Tharp St.
Washington, IN 47501
812-254-0330

J. KEMP INC.

9981 S. 50
Cannelburg, IN 47519
812-295-2068

REX GRESS & SONS, INC.

107 Belle Terre Drive
Washington, IN 47501
812-254-5377

Fabric, Specialty Store

THE STITCHING POST

401 E. Main St.
Washington, IN 47501
812-254-6063

Fair, Non-Profit

DAVIESS COUNTY FAIR, INC.

534 E. SR 57
Elnora, IN 47529
812-486-8071

Farm Equipment

HOEFLING TRUCK & TRACTOR

106 N. 200 E
Washington, IN 47501
812-254-3970

Farm Market

ETIENNE FARM MARKET

2333 S. 300 N
Washington, IN 47501
812-254-7978

PRODUCE PATCH FARM MARKET

2801 E. 825 N
Plainville, IN 47568
812-687-7736

Fertilizer, Crop Chemicals, Mapping, Soil Testing, VRA Application, Seed Sales

HELENA CHEMICAL

248 W. Railroad St.
Montgomery, IN 47558
812-486-3285

Financial

1ST FEDERAL SAVINGS BANK OF WASHINGTON

439 SR 57 S
Washington, IN 47501
812-254-2370

CRANE CREDIT UNION

2102 State St.
Crane, IN 47522
812-854-1414

EDWARD JONES INVESTMENTS

Alan Bubalo
310 S.E. 21st St.
Washington, IN 47501
812-254-1340

EDWARD JONES INVESTMENTS

Eric Bassler
421 E. Main St.
Washington, IN 47501
812-254-3094

EDWARD JONES INVESTMENTS

Sarah Browning
310 S.E. 21st St.
Washington, IN 47501
812-254-3739



Full Financial Services

Banking, Insurance, Investments and Wealth Advisory

Looking for a **home loan, mortgage refinance, business banking, investment services, personal and commercial insurance or wealth advisory services?**

Contact the team at German American Bank for competitive rates and personalized service.



German American Bank

Banking | Insurance | Investments
Member FDIC

Washington: 560 S. SR 57 • 31 Cherry Tree Plaza
Montgomery: 7721 N. 900 E.
(812)254-4630 • germanamerican.com



EDWARD JONES INVESTMENTS

Scott Cordova
416 S. SR 57
Washington, IN 47501
812-254-0342

FIRST FINANCIAL BANK

300 E. Main St.
Washington, IN 47501
812-257-8860

FIRST SAVINGS BANK

501 W. Main St.
Odon, IN 47562
812-636-7324

FORT KNOX INVESTMENT MANAGEMENT

2015 State St.
Washington, IN 47501
812-254-3375

GERMAN AMERICAN BANK

560 S. SR 57
Washington, IN 47501
812-254-4630

GFI INVESTMENT LLC

P.O. BOX 391
Washington, IN 47501
812-617-0724

HOME BUILDING SAVINGS BANK, FSB

200 E. Van Trees St.
Washington, IN 47501
812-254-2641

OLD NATIONAL BANK

311 S.E. 21st St.
Washington, IN 47501
812-254-1760

SPRINGS VALLEY BANK AND TRUST

1500 Main St.
Jasper, IN 47546
800-843-4947

WOODFOREST BANK

1801 S. SR 57
Washington, IN 47501
812-257-1096

Fire, Fire Ext. Svc., Special Services

DERBY FIRE & SAFETY

202 N. Main St.
Cannelburg, IN 47519
812-946-0789

Fitness, Education, Speaking

DISTINXION, INC.

205 N College Ave #215
Bloomington, IN 47404
812-486-7506

Fitness, Recreation

DAVISS COUNTY FAMILY YMCA

405 N.E. Third St.
Washington, IN 47501
812-254-4481

H2A2/DBA ANYTIME FITNESS

101 Cherry Tree Plaza
Washington, IN 47501
812-254-2200

Florist, Retail, Home Décor

EASTSIDE FLOWERS & GIFTS

107 E. Main St.
Washington, IN 47501
812-642-5002

THE COUNTRY GARDEN

2107 State St.
Washington, IN 47501
812-674-0078

Funeral Home

ED LEE MORTUARY

101 N. Meridian St.
Washington, IN 47501
812-254-3612

GILL FUNERAL HOME

308 E. Walnut St.
Washington, IN 47501
812-254-5650

GOODWIN-SIEVERS FUNERAL HOME

2020 State St.
Washington, IN 47501
812-254-5111

Furniture, Home Décor

INTERIOR FURNITURE & APPLIANCE GALLERY LLC

744 S. SR 57
Washington, IN 47501
812-2571927

Furniture, Home Décor, Cabinets, Kitchen & Bath

RABER'S FURNITURE, LLC

3297 N. 775 E
Montgomery, IN 47558
812-486-3571

Gas Station

CE TAYLOR OIL, INC.

10105 Hedden Road
Evansville, IN 47725
812-602-3290

HERITAGE PETROLEUM

504 W. Walnut St.
Washington, IN 47501
812-254-3671

Gas Stations, Retail

CASEY'S GENERAL STORE

2009 E. National Hwy. and Hwy. 57
Washington, IN 47501
812-254-2301

CASEY'S GENERAL STORE

101 W. Elnora St.
Odon, IN 47562
812-636-0333

Golf, Recreation

COUNTRY OAKS GOLF CLUB

5064 E. US 50
Montgomery, IN 47558
812-486-3300

Government / Services

CITY OF WASHINGTON

200 Harned Ave.
Washington, IN 47501
812-254-6143

NSWC CRANE DIVISION

300 Hwy. 361, Bldg. 1, Code 052
Crane, IN 47522
812-854-3239

PACE COMMUNITY ACTION AGENCY

525 N. Fourth St.
Vincennes, IN 47591
812-882-7927

WASHINGTON HOUSING AUTHORITY

520 S.E. Second St.
Washington, IN 47501
812-254-1596

Government Services, Economic Development

DAVISS COUNTY ECONOMIC DEVELOPMENT CORP.

219 E. Main St.
Washington, IN 47501
812-254-1500

Etiennes' Farm, Inc.

Retail & Wholesale
H-N Grown Produce & Plants

OPEN MID APRIL - OCT. 29TH

Junct. Hwy. 50 W & Maysville Rd., Washington, IN 47501
Mkt. (812) 254-7978 • Home (812) 254-6659

We also stock Bear Hollow Mulch



MARK J. GRABER
Auctioneer / Real Estate Broker



Taking Consignments For
Trucks - Cars - Trailers - RV's - Tractors - Fork Trucks - Equipment
Mowers - Golf Carts - ATV's - Etc.

GRABER AUCTIONS

Public Auto Auction First Saturday of Every Month

1382 S. State Road 257
Washington, IN 47501
AU19400133

Office: 812-254-2220
www.graberauctions.com

**Government
Services,
Rentals,
US Guard,
Employment**

**INDIANA ARMY
NATIONAL GUARD**
500 N.E. Sixth St.
Washington, IN
47501
812-254-3354

Groceries

**PRICE LESS/
HOUCHENS FOOD
GROUP**
900 W. National
Hwy.
Washington, IN
47501
812-254-6644

SAVE-A-LOT
300 S.E. 21st St.
Washington, IN
47501
812-254-7896

**Hardware,
Construction**

A & R SUPPLY
6 Cumberland
Drive
Washington, IN
47501
812-254-7018

**Hardware,
Welding,
Manufacturing**

**GRABER STEEL &
FABRICATION, LLC**
8528 N. 900 E
Odon, IN 47562
812-636-7733

Health Care

AIR EVAC
617 Delaware St.
Evansville, IN 47710
812-568-6488

**CULLEN MEDICAL
PROFESSIONALS
CORP.**
2005 State St., Suite A
Washington, IN
47501
812-254-4650

**DAVISS
COMMUNITY
HOSPITAL**
1314 E. Walnut St.
Washington, IN
47501
812-254-2760

**GOOD SAMARITAN
HOSPITAL**
520 S. Seventh St.
Vincennes, IN
47591
812-885-3336

**MEMORIAL
HOSPITAL &
HEALTH CARE
CENTER**
800 W. Ninth St.
Jasper, IN 47546
812-996-2323

**Health Care,
Chiropractic**

**BOWLING
CHIROPRACTIC
CENTER, PC**
312 E. Main St.
Washington, IN
47501
812-254-0246

**OMER
CHIROPRACTIC
CLINIC**
501 S.E. Second St.
Washington, IN
47501
812-254-0476

**Health, Fitness,
Yoga**

YOGA ON MAIN
318 E. Main St.
Washington, IN
47501
812-259-8059

**Hearing Aid
Specialist,
Retail**

**HOMETOWN
HEARING –
WASHINGTON**
420 S. SR 57
Washington, IN
47501
812-882-2075

**Heating, A/C,
Plumbing**

**BUCHANAN
MECHANICAL, INC.**
369 S. 150 W
Washington, IN
47501
812-254-0936

**HAAG HEATING
& AIR
CONDITIONING**
208 N.W. Sixth St.
Washington, IN
47501
812-254-4561

**Heavy
Machinery**

**MACALLISTER
MACHINERY**
1453 W. 150 S
Washington, IN
47501
812-254-1712

**Home Care,
Healthcare,
Medical
Services**

**GOOD SAMARITAN
HOME CARE**
413 N. First St.
Vincennes, IN
47591
812-885-2767

**NASCO IS PROUD
TO BE A PART OF
AND SUPPORT
OUR LOCAL
COMMUNITY
SINCE 1979.**



NASCO

Protective Outerwear Solutions

Proudly made in Washington, IN

nascoinc.com

Home Décor, Gourmet Food, Beauty Products, Wellness Consultant, Honey, Syrups & Jellies

CATHY MCKOWN: INDEPENDENT CONSULTANT

2362 E. 400 S
Washington, IN 47501
812-486-7476

Individual

DAVID B. GRAHAM

1550 Killingsworth Way
Apt. 301
The Villages, FL 32162
812-254-6633

MCDONALD, JERRY

1600 N. Donny Davies
Drive
Washington, IN 47501
812-254-2863

Industry

GRAIN PROCESSING CORPORATION

1443 S. 300 W
Washington, IN 47501
812-257-2735

Information Technology, Internet Service

RTC COMMUNICATIONS

244 N. Main St.
Montgomery, IN 47558
812-486-3211

Information Technology, Repair, Services, Retail, Computer Repair

CPU FIX UP

402 E. Main St.
Washington, IN 47501
812-200-0349

Insurance

ADVANTUS

10100 Lantern Road,
Ste 150
Fishers, IN 46037
800-235-8541

AFLAC

1745 N. 75 E
Washington, IN 47501
812-698-9391

CRITCHLOW AGENCY

9 S.E. Second St.
Washington, IN 47501
812-254-4864

GERMAN AMERICAN INSURANCE

560 S SR 57
Jasper, IN 47547
812-254-4850

TERRI KELSO INSURANCE

2108 State St., Suite B
Washington, IN 47501
812-254-7770

THE INSURANCE SHOP, INC.

204 W. Main St.
Odon, IN 47562
812-636-2222

THOMPSON INSURANCE

514 E. Main St.
Washington, IN 47501
812-254-1987

UNITED INSURANCE SERVICES, INC.

209 E. Main St.
Washington, IN 47501
812-254-3560

Insurance, Travel, Financial

HOOSIER INSURANCE & FINANCIAL SERVICE, INC.

314 E. Main St.
Washington, IN 47501
812-254-2688

Interior Design

ART CARPET CO.

11 S.E. First St.
Washington, IN 47501
812-254-1647

PREMIER FLOORING & MILLWORKS

2000 E. National Hwy.
Washington, IN 47501
812-257-0700

Landscaping & Produce Market

WICHMAN'S LANDSCAPE, LLC

112 E. 575 N
Washington, IN 47501
812-257-1255

Lawn Care, Landscaping, Excavating

T & T LAWN CARE, LANDSCAPING & EXCAVATING

215 13th St.
Bloomfield, IN 47424
812-699-9385

Legal Services

HAYES & DANT

19 N.E. Third St.
Washington, IN 47501
812-254-1419

JEFFREY R. NORRIS, ATTORNEY AT LAW

405 E. Main St.
Washington, IN 47501
812-254-2740

KAHN, DEES, DONOVAN & KAHN, LLP

501 Main St.
Evansville, IN 47708
812-423-3183

Legal Services, Document Preparation

DIANE JOYCE/LEGAL SHIELD INDEPENDENT CONSULTANT

Indianapolis, IN 46278
317-657-2766

Locks

LENTS LOCK & SAFE

11 W. Main St.
Washington, IN 47501
812-254-7698



Lodging

BAYMONT INN & SUITES
7 Cumberland Drive
Washington, IN 47501
812-254-7000

BUDGET INN
412 E. South St.
Washington, IN 47501
812-254-5816

GASTHOF VILLAGE INN
6747 E. Gasthof Village Road
Montgomery, IN 47558
812-486-2600

GRABER GREEN GABLES
8824 N. 900 E
Odon, IN 47562
812-636-4399

HOLIDAY INN EXPRESS
1808 E. National Hwy.
Washington, IN 47501
812-254-6666

THEROFF'S MOTEL
2001 E. National Hwy.
Washington, IN 47501
812-254-4279

Logistics

ALTRESS TRUCKING
220 W. 440 N
Washington, IN 47501
812-254-7726

INDIANA SOUTHERN RAILROAD, INC.
200 Meridian Centre Blvd., Suite 300
Rochester, NY 14618

M. A. DAVIS TRUCKING LOGISTICS, INC.
1211 W 300 S
Washington, IN 47501
812-254-1042

MYERS TRANSPORTATION
5668 N. SR 57
Washington, IN 47501
812-254-6809

TGP EXPRESS, LLC
511 N. 450 E
Washington, IN 47501
502-396-3584

T. S. BOYD
1957 E. 200 N
Washington, IN 47501
812-254-5599

Manufacturing, Service, Precast Concrete

REX VAULT SERVICE OF ODON
714 W Elnora St.
Odon, IN 47562
812-636-7386

Manufacturing

BASILOID PRODUCTS CORP.
312 N. East St.
Elnora, IN 47529
812-692-5511

CORNELIUS MANUFACTURING
5344 E. 1250 N
Elnora, IN 47529
812-636-4319

DAVISS COUNTY METAL SALES, INC.
9929 E. US 50
Cannelburg, IN 47519
812-486-4299

ISOFLEX PACKAGING
1842 E. Waller Drive
Washington, IN 47501
812-610-8400

NASCO INDUSTRIES
3 N.E. 21st St.
Washington, IN 47501
812-254-7393

Manufacturing, Oil

GWALTNEY DRILLING
107 S.E. Third St.
Washington, IN 47501
812-254-5085

Marketing TV, Advertising

WTHI-TV 10
1911 College Ave.
Vincennes, IN 47591
812-887-5871

WTWO-TV
P.O. Box 299
Terre Haute, IN 47808
812-696-2121

Marketing, Marketing Communications

TEXTWORKS COPYWRITING LLC/LITTERA
1419 Brett Cabel Road
Washington, IN 47501
812-617-1377

THE CREATIVEEDGE LLC
107 E. Main St.
Washington, IN 47501
812-642-5090

Marketing, Printing

TIMES MAIL
813 16th St.
Bedford, IN 47421
812-277-7213

DONALDSON & SELLERS

Professional Automotive Service



Left to Right: Gary Donaldson - Owner/Technician, Seth Sellers - Owner/Technician, Scott Bruno - Service Manager, Ron Satterfield - Service Manager, Jordan Fields - Technician

VOTED BEST AUTO REPAIR SHOP 2012-2018

"Absolutely the Best!!!...the honesty, knowledge and workmanship are outstanding. They are the best I've ever dealt with." -Sam-

"Great local business! So impressed with the friendliness of the staff, the quick service, and the honest business practice." -Peggy-

OUR TEAM IS READY TO SERVE YOU. GIVE US A CALL TODAY!

COMPLETE Automotive Repair

WITH A 3 YEAR/
36K MILE
NATIONWIDE
WARRANTY

- Tune-Ups
- Brakes and Suspension
- Computer Diagnostics
- Electrical Repairs
- Transmission Services
- Complete Engine Repairs
- A/C Service



201 E. South Street, Washington

812-254-2277

www.DonaldsonSellers.com

Massage, Services, Healthcare

**FEEL KNEADED
MESSAGE TONYA, LLC**
11 N. Meridian St.
Washington, IN 47501
812-698-7429

**SKIN & BODY EMPIRE
MED SPA**
108 Cherry Tree Plaza
Washington, IN 47501
812-254-6810

Meat Processing

ODON LOCKER LLC
606 W. Elnora St.
Odon, IN 47562
812-636-4242

PERDUE FARMS INC.
65 S 200 W
Washington, IN 47501
812-254-8500

Networking, Technology, Business Computers, Information Technology, Telephone

**ECK-MUNDY
ASSOCIATES**
450 E. 11th St.
Jasper, IN 47546
812-634-8001

Newspaper

ODON JOURNAL
102 W. Main St.
Odon, IN 47562
812-636-7350

**VINCENNES SUN-
COMMERCIAL**
702 Main St.
Vincennes, IN 47591
812-886-9955

**WASHINGTON TIMES
HERALD**
102 E. Van Trees St.
Washington, IN 47501
812-254-0480

Non-Profit

**CATHOLIC
COMMUNITY OF
WASHINGTON**
315 N.E. Third St.
Washington, IN 47501
812-254-2883

**CORNING IRISH
HERITAGE CENTER**
4962 S. 800 E
Montgomery, IN 47558
317-250-8766

**DAVISS COUNTY
CASA**
200 W. Walnut St.
Washington, IN 47501
812-254-8652

**DAVISS COUNTY
COMMUNITY
FOUNDATION**
320 E. Main St.
Washington, IN 47501
812-254-9354

**DAVISS COUNTY
HISTORICAL SOCIETY**
P.O. Box 2341
Washington, IN 47501
812-257-0301

**DAVISS COUNTY
MUSEUM**
212 E. Main St.
Washington, IN 47501
812-257-0301

**DAVISS COUNTY
UNITED WAY**
200 E. VanTrees St.
Washington, IN 47501
812-254-1038

**FOUR RIVERS
RESOURCE SERVICES,
INC.**
2212 E. National Hwy.
Washington, IN 47501
812-254-4471

**GOOD SHEPHERD
LUTHERAN CHURCH**
1002 ½ N.E. Sixth St.
Washington, IN 47501
812-254-0950

**PREGNANCY CARE
CENTER**
705 Troy Road
Washington, IN 47501
812-257-1041

**SALVATION ARMY OF
DAVISS COUNTY**
4020 Georgetown
Road
Indianapolis, IN 46254
317-224-1055

SAMARITAN CENTER
520 S. Seventh St.
Vincennes, IN 47591
812-886-680

**SENIOR & FAMILY
SERVICES**
211 E. Main St.
Washington, IN 47501
812-254-1881

**SOUTHWEST INDIANA
POWERHOUSE**
709 E. Main St.
Washington, IN 47501
812-254-7693

**VEALE CREEK
THEATRE**
4170 Hwy. 57 S
Washington, IN 47501
812-254-9065

**VINCENNES
GOODWILL
INDUSTRIES/
WASHINGTON
BRANCH**
900 W. National Hwy.
Washington, IN 47501
812-254-6927

Nursing Home, Health Care

**BERTHA D. KETCHAM
MEMORIAL CENTER**
601 E. Race St.
Odon, IN 47562
812-636-4920

EASTGATE MANOR
2119 E. National Hwy.
Washington, IN 47501
812-254-3301

HILLSIDE MANOR
1109 E. National Hwy.
Washington, IN 47501
812-254-7159

**WASHINGTON
NURSING CENTER**
603 E. National Hwy.
Washington, IN 47501
812-254-5117

Office Supply

**HUDSON OFFICE
SOLUTIONS**
708 E. Main St.
Washington, IN 47501
812-254-0495

OFFICE CONNECTION
104 Broadway St.
Vincennes, IN 47591
812-886-9905

Optometrist, Health Care

**EYEWORKS/HENDRIX
OPTOMETRIC CORP.**
109 Cherry Tree Plaza
Washington, IN 47501
812-254-1600

**DR. RICHARD HALE,
OD**
106 E. Main St.
Washington, IN 47501
812-254-1190

**ODON OPTICAL
INC. – DR. DAVID
WINTERGERST**
101 E. Elnora St.
Odon, IN 47562
812-636-8030

ECONOMIC DEVELOPMENT FOUNDATION, INC.

Daviess County • A Great Place to Live



**Solid Workforce • New Continental Access
Proven Place to Grow**

**219 E. Main St., Suites A-B
Washington, IN
812-254-1500 • bniehoff@dcdec.net**



BUSINESS SOLUTIONS

- Computer Systems
- Computer Networks/Servers
- Managed Services
- Malware/Ransomware Protection
- Managed Internet Access
- Multi-Function Printers/Copiers/Scanners
- Telephone Systems
- Remote/On Site/In Shop Service



Our SOLUTIONS keep your business on top!

450 E. 11th Avenue - Jasper • 812-634-8001 • eck-mundy.com

Paint & Supply Store

SHERWIN WILLIAMS
101 E. Main St.
Washington, IN 47501
812-254-4726

Pest Control

ADVANCED PEST SOLUTIONS
1035 N. Saint Johns Road
Washington, IN 47501
812-698-1012

HAND'S TERMITE & PEST CONTROL, INC.
207 E. South St.
Washington, IN 47501
812-254-5208

Pharmacy, Health Care

ODON PHARMACY
200 W. Main St.
Odon, IN 47562
812-636-4600

PRESCRIPTION SHOPPE
2005 State St.
Washington, IN 47501
812-254-7666

WILLIAMS BROS. HEALTH CARE PHARMACY
10 Williams Bros. Drive
Washington, IN 47501
812-254-2497

Poolery

S & S POOLS & SUPPLY INC.
691 W. 150 S
Washington, IN 47501
812-254-5006

Postal, Government

USPS
405 Center St.
Washington, IN 47501
812-254-0011

Printing, Advertising

EWING PRINTING
516 Vigo St.
Vincennes, IN 47591
812-882-2415

INDIANA FORMS & LABELS PROMOTIONS
1648 E. 675 S
Washington, IN 47501
812-644-7744

Radio, Advertising

DLC MEDIA/WAMW FM & AM
800 W. National Hwy.
Washington, IN 47501
812-254-6761

WBDC/WRZR/ WJTSTV 18
P.O. Box 1009
Jasper, IN 47546
800-504-9587

WWBL – THE ORIGINAL COMPANY
522 Busseron St.
Vincennes, IN 47591
812-254-4300

Real Estate

CENTURY 21
2108 State St.
Washington, IN 47501
812-254-5204

F.C. TUCKER – NORRIS GROUP
412 E. Flora St. #3
Washington, IN 47501
812-254-7939

MIDWEST REALTY & ASSOCIATES
P.O. Box 681
Washington, IN 47501
812-254-3918

RE/MAX REAL ESTATE
510 E. South St.
Washington, IN 47501
812-254-1973

WAGNER & HOPKINS AGENCY
505 E. National Hwy.
Washington, IN 47501
812-254-3253

Recreation

WASHINGTON CONSERVATION CLUB
350 W 150 S
Washington, IN 47501
812-610-2490

Recreation, Club

FRATERNAL ORDER OF EAGLES #414
500 E. Main St.
Washington, IN 47501
812-254-5511

Recreation, Sport Bowling, Entertainment, Games

THE KING PIN BOWLING CENTER
2100 State St.
Washington, IN 47501
812-254-0632

Rehab

LIGHTHOUSE RECOVERY CENTER
311 E. Main St.
Washington, IN 47501
812-257-0860



Rental, Lawn & Garden Repair, Home, Industrial Rental, Construction

GENERAL RENTAL & SALES LLC

102 W. Illinois St.
Petersburg, IN 47567
812-254-2707

Rentals

JAMESTOWN SQUARE WASHINGTON

110 Jamestown Court
Washington, IN 47501
812-254-6394

Rentals, Real Estate

KELLMAR, LLC

1442 N. SR 57
Washington, IN 47501
812-787-0369

Rentals, Real Estate, Storage, Lodging

PEACEFIELD PROPERTY MGMT., LLC

1083 E. 100 N
Washington, IN 47501
812-259-2414

Repair, Services

EAGLE RAILCAR SERVICES

1723 W. Walnut St.
Washington, IN 47501
812-254-8940

Repair, Services, Contractor

1-800 WATER DAMAGE OF SWI

766 E. 200 N
Washington, IN 47501
812-610-4646

Restaurant

ACES

908 Bedford Road
Washington, IN 47501
812-254-2060

AMERICAN TABLE FAMILY DINING

908 W. National Hwy.
Washington, IN 47501
812-674-2018

ARBY'S/BEEF CORP. OF AMERICA

1911 E. National Hwy.
Washington, IN 47501
765-621-0704

GASTHOF AMISH VILLAGE, INC.

6747 E. Gasthof Village Road
Montgomery, IN 47558
812-486-4900

HARDEE'S FOOD SYS. INC.

2004 E. National Hwy.
Washington, IN 47501
812-254-6627

KENTUCKY FRIED CHICKEN

1446 E. National Hwy.
Washington, IN 47501
812-254-2230

LITTLE HOUSTON'S BBQ

711 N. W. 16th St.
Washington, IN 47501
812-887-3421

MCDONALD'S RESTAURANT #5700

2310 N. Sixth St., Ste. B
Vincennes, IN 47591
812-254-1212

PONDEROSA STEAKHOUSE

5 Cumberland Drive
Washington, IN 47501
812-257-0090

SCOOPS HOMEMADE ICE CREAM CO., INC.

424 W. Main St.
Washington, IN 47501
812-257-5126

STOLL'S LAKEVIEW RESTAURANT

15519 US 231
Loogootee, IN 47553
812-295-3299

YOLONDA'S BISTRO

422 E. Main St.
Washington, IN 47501
(812) 642-5091

Retail

GORDMAN'S

117 Cherry Tree Plaza
Washington, IN 47501
712-257-1259

WALMART

1801 SR 57
Washington, IN 47501
812-254-6681

Retail, Clothing

BAMBINI'S FASHION BOUTIQUE

218 E. Main St.
Washington, IN 47501
812-254-0576

TOP NOTCH BOUTIQUE

11 S.E. Third St.
Washington, IN 47501
812-259-9508

Retail, Specialty

AMISH KOUNTRY KORNER

3516 E. US 50
Washington, IN 47501
812-254-3284

DUTCH PANTRY LLC

13014 N. 1100 E
Odon, IN 47562
812-636-7922

LEMON TREE HOME DÉCOR

220 E. Main St.
Washington, IN 47501
812-674-2165

LULAROE PASSION 4 FASHION BOUTIQUE

1987 Troy Road
Washington, IN 47501
812-486-8236



RV Sales, Parts, Trailer Sales

**DUN LOOKIN RV
WHOLESALE, LLC**
1999 S. SR 57, Bldg. 3
Washington, IN 47501
812-698-1428

Salon & Spa

**MERAKI SALON &
SPA**
205 S.E. Second St.
Washington, IN 47501
812-259-2602

Security

AREA 1 PROTECTION
12410 E. US 50
Loogootee, IN 47553
812-787-0140

Septic Service

**RABER'S SEPTIC
SERVICE &
PORTABLE TOILETS**
2432 N. 750 E
Montgomery, IN
47558
812-787-2233

Services

**HOOSIER BUSINESS
MACHINES, INC.**
808 N. Main St.
Jasper, IN 47547
812-482-3736

**MAYSVILLE
ENTERPRISES, LLC**
1250 S. 300 W
Washington, IN 47501
812-257-1112

**PORTER TV SALES
LLC**
7595 E. 1400 N
Elnora, IN 47529
812-636-4206

**WILLIAMS FIRE &
HAZARD CONTROL,
INC.**
P.O. Box 742
Washington, IN 47501
812-254-1962

Sporting Goods, Firearms, Consignment, Retail

**PRECISION
OUTDOORS**
5382 S. 800 E
Montgomery, IN
47558
812-644-7602

Staffing Agency

CUSTOM STAFFING
1820 N. Green River
Road
Evansville, IN 47715
812-474-7400

**PREMIER STAFFING
SOLUTIONS**
308 W. National Hwy.
Washington, IN 47501
812-254-2140

Surveying

**GABHART LAND
SURVEYING, INC.**
10 N.E. Fourth St.
Washington, IN 47501
812-254-1309

**LANDMARK
SURVEYING CO., INC.**
15 N.E. Third St.
Washington, IN 47501
912-257-0950

**MIDWESTERN
ENGINEERS**
802 W. Broadway St.
Loogootee, IN 47553
812-295-2800

Tanning, Salon, Skin Care, Specialty

SUNSATONAL TANS
1392 S. SR 57
Washington, IN 47501
812-674-2826

Telephone, Cell Phone Service, Internet Service

**NEW WAVE
COMMUNICATIONS**
102 N. Fifth St.
Vincennes, IN 47591
812-895-7676

Tires

YODER TIRE LLC
111 S. Main St.
Cannelburg, IN 47519
812-486-3609

The
Stitching Post

*Family Owned
& Operated
Since 1986*



**Southwest Indiana's largest quilt
store with over 10,000 bolts!**

Stop in or Shop our Online Catalog:
<http://stitchingpostquilts.com>

401 E. Main St. • Washington, IN
812-254-6063
Hrs. Mon.-Sat 10am-5pm 

Landmark Surveying Co., Inc.



Darren L. Helms
Dennis N. Helms
Professional Land Surveyor
dlh.landmark97@sbcglobal.net

Hogan L. Helms
Professional Engineer
hhlh.landmark97@sbcglobal.net

812-257-0950

15 N.E. 3rd St. • Washington, IN 47501

Tourism

DILLON AMISH TOURS

5388 S. 800 E
Montgomery, IN 47558
812-296-1775

Trash

AYD TRASH SERVICE

8475 E. 1475 N
Odon, IN 47562
812-296-6000

Trailer Sales, Repair, Retail Trailer Sales

SHARP TRAILER SALES, LLC

637 E. SR 57 North
Elnora, IN 47529
812-692-5288

Tree Services

G E TREE SERVICE

1202 E. Spruce St.
Petersburg, IN 47568
812-354-6119

Trucking, Chemicals, Logistics

QUEST LINER TRUCKING

2869 S. SR 57
Washington, IN 47501
812-254-7914

Trucking, Hauling

CLIFFORD KNEPP TRUCKING, LLC

9377 E. 1025 E
Odon, IN 47562
812-486-7500

JT EXPRESS, INC.

311 N. 350
Washington, IN 47501
812-257-8901

LRW TRUCKING

7696 N. 150 E
Washington, IN 47501
812-486-5463

SWARTZENTRUBER TRUCKING, INC.

10354 N. 475 E
Odon, IN 47562
812-254-1987

Used Auto Sales

CERTIFIED AUTO EXCHANGE

316 E. National Hwy.
Washington, IN 47501
812-254-9100

Utilities

DAVISS COUNTY RURAL WATER SYSTEM, INC.

1082 N 350 E
Washington, IN 47501
812-254-4526

DAVISS/MARTIN COUNT REMC

12628 E 75 N
Loogootee, IN 47553
800-762-7362

DUKE ENERGY

800 Old Wheatland Road
Vincennes, IN 47591
812-886-3280

IMPA/INDIANA MUNICIPAL POWER AGENCY

11610 N. College Ave.
Carmel, IN 46032
317-575-3879

IPL PETERSBURG

4980 N. Park Lane Drive
Petersburg, IN 47567
812-354-7233

MAY'S GAS SERVICE, INC.

1431 SR 57
Washington, IN 47501
812-254-577

MIDWEST NATURAL GAS CORP.

107 S.E. Third St.
Washington, IN 47501
812-254-5087

VECTREN, INC.

301 E. Oak St.
Washington, IN 47501
812-449-1294

Veterinarian

WASHINGTON VETERINARY HOSPITAL, LLC

209 S.E. Third St.
Washington, IN 47501
812-254-7535

Videographer, Video Production, Video Service

MAW VIDEO PRODUCTION

P.O. Box 753
Washington, IN 47501
812-698-8444

Water Treatment, Bottled Water Delivery

CULLIGAN WATER

2450 Marantha Lane
Vincennes, IN 47591
812-882-2763



	MEMBER 1-19 EMP	BRONZE 20+ EMP	SILVER	GOLD
CHAMBER MEMBERSHIP BENEFITS	\$200	\$500	\$1,000	\$3000
Positive & Proven Credibility as Chamber Member (Priceless)	<input checked="" type="checkbox"/>	<input checked="" type="checkbox"/>	<input checked="" type="checkbox"/>	<input checked="" type="checkbox"/>
Free Radio Advertising WAMW (\$200 value)	<input checked="" type="checkbox"/>	<input checked="" type="checkbox"/>	<input checked="" type="checkbox"/>	<input checked="" type="checkbox"/>
Free Radio Advertising and TOC Direct Disc. (\$450 value WWBL)	<input checked="" type="checkbox"/>	<input checked="" type="checkbox"/>	<input checked="" type="checkbox"/>	<input checked="" type="checkbox"/>
Free Newspaper Display Ads (new members) (\$200 value)**	<input checked="" type="checkbox"/>	<input checked="" type="checkbox"/>	<input checked="" type="checkbox"/>	<input checked="" type="checkbox"/>
Member Only Business Referrals	<input checked="" type="checkbox"/>	<input checked="" type="checkbox"/>	<input checked="" type="checkbox"/>	<input checked="" type="checkbox"/>
Chamber Bucks Program (listed in business' accepting list)	<input checked="" type="checkbox"/>	<input checked="" type="checkbox"/>	<input checked="" type="checkbox"/>	<input checked="" type="checkbox"/>
Copy Services for Members Only (10¢ color, 5¢)	<input checked="" type="checkbox"/>	<input checked="" type="checkbox"/>	<input checked="" type="checkbox"/>	<input checked="" type="checkbox"/>
Events posted in Chamber Newsletter	<input checked="" type="checkbox"/>	<input checked="" type="checkbox"/>	<input checked="" type="checkbox"/>	<input checked="" type="checkbox"/>
Member Specials posted in Chamber Facebook Page	<input checked="" type="checkbox"/>	<input checked="" type="checkbox"/>	<input checked="" type="checkbox"/>	<input checked="" type="checkbox"/>
(5B2B) Chamber Business to Business Discounts	<input checked="" type="checkbox"/>	<input checked="" type="checkbox"/>	<input checked="" type="checkbox"/>	<input checked="" type="checkbox"/>
Ribbon Cuttings (new business or new location)	<input checked="" type="checkbox"/>	<input checked="" type="checkbox"/>	<input checked="" type="checkbox"/>	<input checked="" type="checkbox"/>
Bulk Mail USPS Rate (bulk .290/.307 as 10/16)	<input checked="" type="checkbox"/>	<input checked="" type="checkbox"/>	<input checked="" type="checkbox"/>	<input checked="" type="checkbox"/>
Opportunity to host/sponsor events	<input checked="" type="checkbox"/>	<input checked="" type="checkbox"/>	<input checked="" type="checkbox"/>	<input checked="" type="checkbox"/>
Opportunity to host Business After Hours (additional cost varies)	<input checked="" type="checkbox"/>	<input checked="" type="checkbox"/>	<input checked="" type="checkbox"/>	<input checked="" type="checkbox"/>
Recognition in e-newsletter	<input checked="" type="checkbox"/>	<input checked="" type="checkbox"/>	<input checked="" type="checkbox"/>	<input checked="" type="checkbox"/>
Chamber Member Mailing List (one set of labels per yr. w/ request)	<input checked="" type="checkbox"/>	<input checked="" type="checkbox"/>	<input checked="" type="checkbox"/>	<input checked="" type="checkbox"/>
Membership Window Decal	<input checked="" type="checkbox"/>	<input checked="" type="checkbox"/>	<input checked="" type="checkbox"/>	<input checked="" type="checkbox"/>
Free Notary Service (\$25 each)	<input checked="" type="checkbox"/>	<input checked="" type="checkbox"/>	<input checked="" type="checkbox"/>	<input checked="" type="checkbox"/>
Link to Member Website from daviesscountychamber.com	<input checked="" type="checkbox"/>	<input checked="" type="checkbox"/>	<input checked="" type="checkbox"/>	<input checked="" type="checkbox"/>
Electronic list of Member business mailing addresses	<input checked="" type="checkbox"/>	<input checked="" type="checkbox"/>	<input checked="" type="checkbox"/>	<input checked="" type="checkbox"/>
Job Openings posted on Chamber Website and Facebook		<input checked="" type="checkbox"/>	<input checked="" type="checkbox"/>	<input checked="" type="checkbox"/>
Priority Seating at Event*			<input checked="" type="checkbox"/>	<input checked="" type="checkbox"/>
Logo on Chamber Website (\$100 value)			<input checked="" type="checkbox"/>	<input checked="" type="checkbox"/>
Recognition at Annual Dinner (up to \$360 value)			<input checked="" type="checkbox"/>	Program
Golf Scramble Sponsorship or Team (\$300 value golf only for 4)			<input checked="" type="checkbox"/>	
Golf Scramble Team and Sponsorship (\$550 value (4) Entertainment pack)				<input checked="" type="checkbox"/>
Complimentary Table of 8 to Annual Dinner (\$240 value)				<input checked="" type="checkbox"/>
Logo Displayed at All Chamber Annual Events (\$200 value)				<input checked="" type="checkbox"/>
"Featured Member" on website with link to webpage (\$400 value)				<input checked="" type="checkbox"/>
Waived Business After Hours hosting fee *** (\$300 value)				<input checked="" type="checkbox"/>
	Over \$800 value	\$1150 value	\$1900 value	\$3500 value

Rollin' Mini Barns

**6950 E 800N
Odon, IN
812-687-7581**

*Your premier
shed
destination!*

*Serving
300-mile radius
Southern IN &
Kentucky*

Built with quality material used in home construction

Why pay for this?



**When you can have
this instead...**



*All metal and metal
trim supplies by*



**15 Locations
to serve you**

ODON, IN
WASHINGTON, IN
BLOOMFIELD, IN
JASPER, IN
FOUNTAIN TOWN, IN
FLAT ROCK, IN
FRANKLIN, IN
MADISON, IN
GEORGETOWN, IN
TELL CITY, IN
LOUISVILLE, KY
SHEPHERDSVILLE, KY
ELIZABETHTOWN, KY
OWENSBORO, KY
BRANDENBURG, KY

Rollin Mini Barns LLC was established in 2003. The owners have a hands-on, everyday involvement with a dedicated crew with 150 years of combined experience. Our buildings are of the highest quality with our attention to detail unmatched by mass produced sheds.

Rollin Mini Barns is a full service shed supplier. 12 models offered as standard that can be customized and we also build fully customized buildings. We have our own state-of-the-art delivery equipment.

Rent to own - No credit check - Contract required - 10% down - Minimum \$150